

AGRICULTURAL TELESCOPIC CYLINDERS

These tipping cylinders, also known as tipping rams, are designed to cater to a wide range of agricultural tipping applications, with lifting capacities typically ranging from 4 tonnes to 18 tonnes in 2 to 4 stages. Recognizing the demanding environments these cylinders operate in, they are manufactured using, bespoke designs to ensure maximum durability and minimize downtime.



FEATURES

Standard Features throughout the range.

- Single-acting
- Provision for grease nipples at both ends
- Headed gland nuts for reducing servicing downtime
- Zinc plated glands nuts for added corrosion resistance
- Double lipped asymmetric piston seal design manufactured in high-performance polyurethane
- Heavy-duty wiper ring featuring a front flap that covers the gland face preventing a water/slurry trap so common with conventional wiper
- Piston bearing rings: all pistons fitted with two bearings to give maximum internal support, manufactured to very tight tolerances and made from woven fabric reinforced with a polyester resin
- Gland bearing rings: all gland nuts fitted with 30/40mm long hard-wearing Acetal bearing strip

SPECIFICATIONS

TUBE:-- All tubes manufactured from ready to use smooth bore, EN10305-2 specification, E355 steel grade. If required chrome plated, the tubes are finished with a hard chrome plate deposit minimum thickness 0.025mm

ROD:-- All rods are hard chrome plated.

ALL PISTON TYPE TELESCOPIC HYDRAULIC CYLINDERS ARE PRESSURE TESTED ON A PURPOSE-BUILT RIG TO A PRESSURE OF 241 BAR (3500 PSI) AND THEN STAMPED WITH PART, JOB, & SERIAL NUMBERS, WEIGHT, MANUFACTURE DATE AND MAX W/PRESSURE FOR FULL IDENTIFICATION. ALL TONNAGES CALCULATED AT 2000 PSI (137 BAR).

METRIC STAGE CYLINDERS

Metric Agricultural Telescopic Cylinders are a specific type of hydraulic cylinder designed for agricultural applications, where precise measurements and compact design are essential. The "metric" aspect refers to the cylinder's dimensions being specified in the metric system, often with precise bore and stroke measurements tailored for international or specific regional standards.

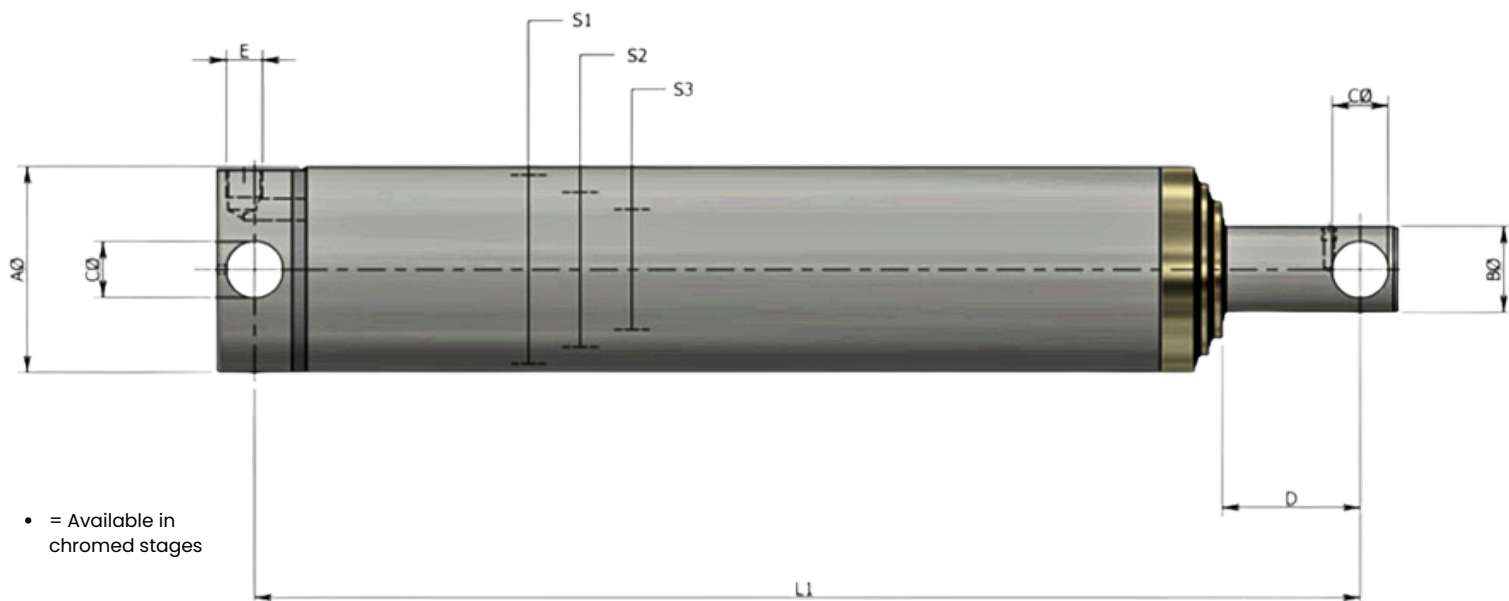

PART NUMBER	STAGES	TONNE/STAGE AT 2000 PSI (137 BAR)	L1 CLOSED CENTRES	STROKE	OPEN CENTRES	S1 BORE	S2 BORE	S3 BORE
M900/A*	3	13 - 9 - 5	1245	2821	4066	110	90	70
M900/B*	3	13 - 9 - 5	914	2032	2946	110	90	70
M900/C*	3	13 - 9 - 5	1092	2449	3541	110	90	70
M900/E*	3	13 - 9 - 5	1016	2323	3339	110	90	70
M901/A-CHROMED	3	11 - 7 - 4	924	1993	2917	100	80	60
M902/C*	2	13 - 9	914	1370	2284	110	90	X
M909/E-CHROMED	2	11 - 5	914	1384	2298	100	80	X

PART NUMBER	A Ø	B Ø	C Ø	D	E BSP	OIL CAPACITY (LITRES)	WEIGHT (KG)
M900/A*	120	50	31.75	109	1/2"	18.6	64
M900/B*	120	50	31.75	41	1/2"	13.4	49.5
M900/C*	120	50	31.75	80	1/2"	16.2	57.2
M900/E*	120	50	31.75	46	1/2"	15.3	52
M901/A-CHROMED	110	45	25.4	74	1/2"	10.5	41.6
M902/C*	120	50	31.75	50	1/2"	10.8	43.2
M909/E-CHROMED	110	45	25.4	63	1/2"	8.1	34.1

IMPERIAL STAGE CYLINDERS

Imperial Agricultural Telescopic Cylinders are hydraulic cylinders designed specifically for agricultural machinery, with dimensions and measurements based on the imperial system (inches). These cylinders are often used in agricultural applications where space-saving and high-performance lifting are necessary.

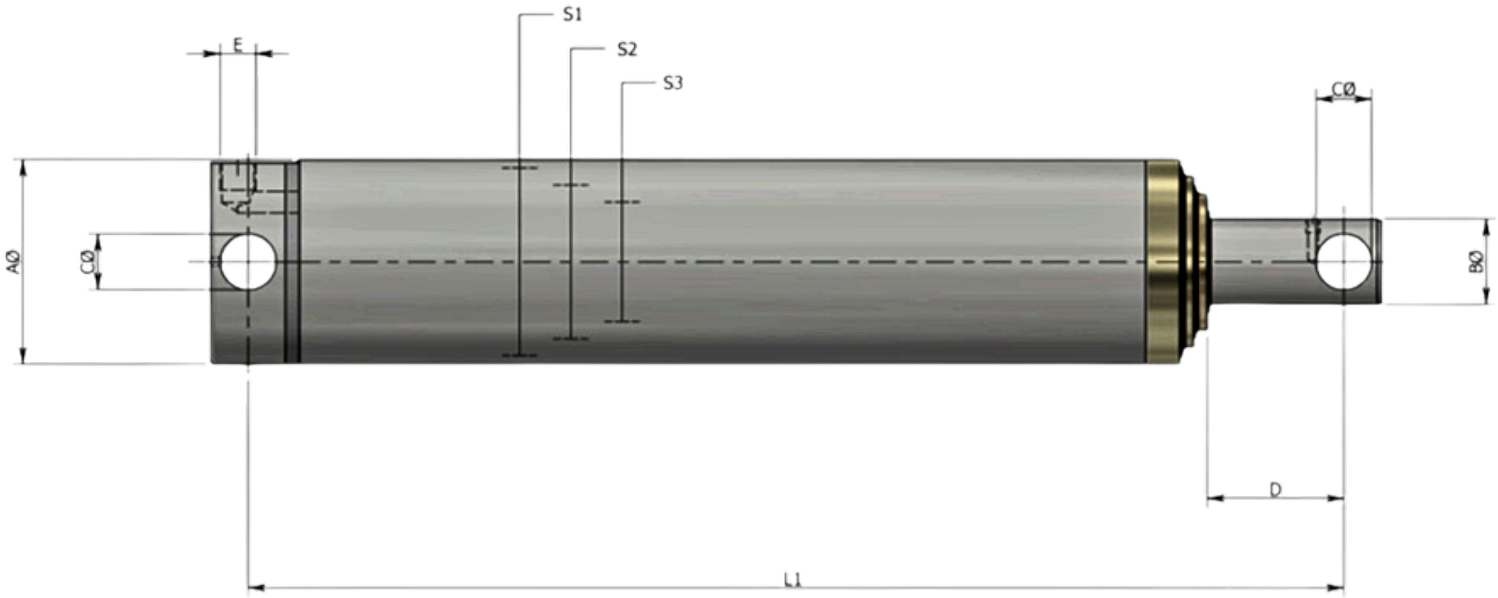

PART NUMBER	STAGES	TONNE/STAGE AT 2000 PSI (137 BAR)	L1 CLOSED CENTRES	STROKE	OPEN CENTRES	S1 BORE	S2 BORE	S3 BORE
C901/A	3	10 - 7 - 4	924	1993	2917	3.75"	3"	2.375"
C909/A	2	10 - 5	876	1375	2251	2.75"	2.75"	X
C909/E	2	10 - 5	914	1384	2298	2.75"	2.75"	X
C916/A	2	4 - 2	533.5	700	1233.5	1.75"	1.75"	X
C916/B	2	4 - 2	660	953	1613	1.75"	1.75"	X
C916/C	2	4 - 2	737	1107	1844	1.75"	1.75"	X

PART NUMBER	A Ø	B Ø	C Ø	D	E BSP	OIL CAPACITY (LITRES)	WEIGHT (KG)
C901/A	105	44.45	25.4	72	1/2"	9.7	38
C909/A	105	44.45	25.4	45	1/2"	7.5	31
C909/E	105	44.45	25.4	78.5	1/2"	7.6	31.5
C916/A	70	31.75	20.25	38	3/8"	1.5	11
C916/B	70	31.75	20.25	38	3/8"	2.1	13.5
C916/C	70	31.75	20.25	38	3/8"	2.4	15