

# 316 Stainless Steel Twin Ferrule Metric Tube Fittings

## Union Elbow

### Tube x Tube

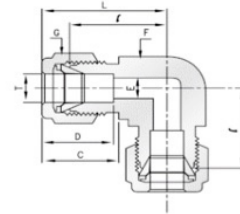

Part No	T mm	E MIN	h mm	H mm	F	G	I	L
UE-3	3	2.4	9.5	12	12.9	15.3	15.7	22.3
UE-4	4	2.4	12.7	12	13.7	16.4	18.8	25.4
UE-6	6	4.8	12.7	14	15.3	17.7	19.6	27.0
UE-8	8	6.4	14.3	16	16.2	18.6	21.3	28.8
UE-10	10	7.9	17.5	19	17.2	19.5	23.9	31.5
UE-12	12	9.5	20.6	22	22.8	22.0	25.9	36.0
UE-15	15	11.9	25.4	25	24.4	22.0	28.7	38.8
UE-16	16	12.7	25.4	25	24.4	22.0	28.7	38.8
UE-18	18	15.1	27.0	30	24.4	22.0	29.7	39.8
UE-20	20	15.9	31.8	32	26.0	22.0	32.5	42.6
UE-22	22	18.3	31.8	32	26.0	22.0	32.5	42.6
UE-25	25	21.8	36.0	38	31.3	26.5	36.8	49.1