

# Hydraulic Imperial Compression Fittings

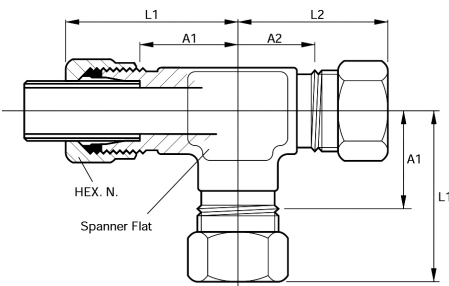
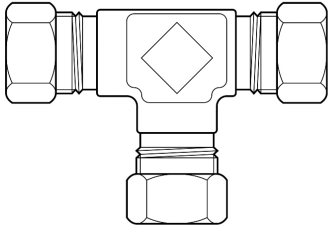

## O.D. TUBES

Part No.	Tube Dia. T.	Nut Hexagon N.	A/F Spanner Flat	Tube Abutment A1.	Tube Abutment A2.	O/A Length L1.	O/A Length L2.
T4 2018-9397	1/4"	.710"	.50"	21/32"	15/32"	1 3/8"	1 3/16"
T5 2018-9395	5/16"	.710"	.50"	23/32"	9/16"	1 7/16"	1 9/32"
T6 2018-9403	3/8"	.820"	.710"	13/16"	5/8"	1 11/32"	1 11/32"
T8 2018-9411	1/2"	.920"	.710"	31/32"	23/32"	1 23/32"	1 15/32"
T10 2018-9429	5/8"	1.10"	.96"	1 1/16"	3/4"	1 27/32"	1 17/32"
T12 2018-9437	3/4"	1.20"	.96"	1 5/16"	7/8"	2 1/8"	1 11/16"
T16 2018-9445	1"	1.67"	1.30"	1 19/32"	1 3/32"	2 12/32"	2 1/32"
T24 2018-9460	1 1/2"	2.22"	1.80"	2 5/16"	1 9/16"	3 3/8"	2 5/8"

## N.B. TUBES

Part No.	N.B. Tube Size T.	Nut Hexagon N.	A/F Spanner Flat	Tube Abutment A1.	Tube Abutment A2.	O/A Length L1.	O/A Length L2.
2018-9478	1/4"	1.10"	.968"	1 1/16"	3/4"	1 27/32"	1 17/32"
2018-9486	3/8"	1.20"	.968"	1 5/16"	7/8"	2 1/8"	1 11/16"
2018-9494	1/2"	1.375"	1.062"	1 7/16"	15/16"	2 5/16"	1 13/16"
2018-9502	3/4"	1.67"	1.312"	1 5/8"	1 1/8"	2 5/8"	2 1/8"
2018-9536	1 1/4"	2.58"	2.31"	2 7/16"	1 3/4"	3 17/32"	2 27/32"
2018-9544	1 1/2"	3.02"	2.31"	2 11/16"	1 15/16"	3 3/8"	3 1/8"

Part numbers indicated are for **Carbon Steel Couplings** only.  
For **316 Stainless Steel Couplings**, add suffix **SS** to part number.