

## 88 SERIES, HIGH PRESSURE SCREW-ON COUPLING (CARBON STEEL) BALL VALVE

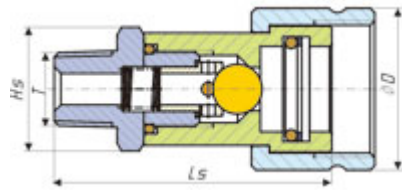

Art. No.	DN	Size	Ls	ØD	Hs	T
HFSFC8814	5.0	04SF	60.5	30	S22	1/4" NPTF
HFSFC8838	6.0	06SF	71.5	36	S24	3/8" NPTF

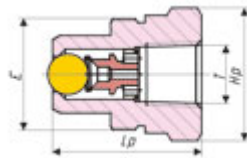

Art. No.	DN	Size	Lp	E	Hp	T
HFSFP8814	5.0	04PF	39	1-18UNS	S19	1/4" NPTF
HFSFP8838	6.0	06PF	40	1-3/16-16UN	S32	3/8" NPTF



ISO	Art. No.(Plug)	Art. No.(Cap)	Material
6.3	PVF	PVM	Steel

### APPLICATIONS:

This Series couplings with their threaded union locking system and precision ball-type check valves, are designed for extreme high pressure applications such as found on portable hydraulic rams.



## PERFORMANCE

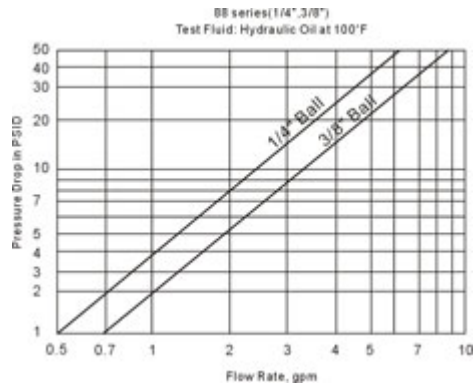

## INTERCHANGE

HANSEN HP3 SERIES, PARKER 3000 SERIES,  
FASTER PVVM SERIES, DNP PVS SERIES,  
STUCCHI IVHP SERIES, SAFEWAY S30 SERIES



## TEMPERATURE RANGE

-25°C+120°C/-13°F+250°F

With standard seals: Buna-N(Nitrile)

On request seals: Viton, Neoprene, EPDM or other seals.



**MAX. WORKING PRESSURE:** 10440PSI(720bar)



## MATERIAL

MATERIAL

Coupler Body :STEEL, TRIVALENT PLATED

Valve :STEEL, BALL TYPE

Springs :C98

Locking O-Ring :C98

Balls :GCr15

Seals :Buna-N(Nitrile)

Back-Up Ring :PTFE

Surface treatment :Zinc plating and Cr 3+ Passivation



## ACCESSORIES:

Dust caps and dust plugs



## ATTENTION:

Only plug and socket with the same thread fit together.