

# BSP Plug

## BSP Plug

### Features:

- High Working Pressure
- Mild Steel - High Grade Material
- Sealing face and threads machined to high tolerance
- High Level Corrosion Resistance Plating (CR3 compliant)
- Available in Stainless Steel 316 or Cupro Nickel
- Bonded Seal Centring Cone

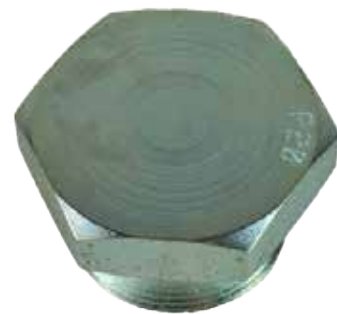

### Benefits:

- Highly resistant to leakage even under severe vibration, pressure pulsation and temperature

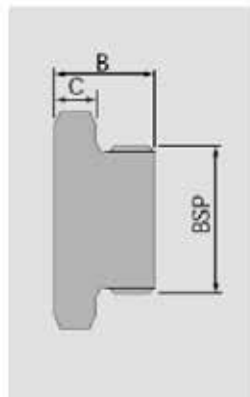

Stud BSP	Part No	B mm	C mm	Nut A/F mm	Nut A/C mm	* Max WP Bar
1/8	KRP2	17	7	14	16.2	680
1/4	KRP4	18	7	19	21.9	680
3/8	KRP6	21	8	22	25.4	680
1/2	KRP8	25	9	27	31.2	680
5/8	KRP10	26	10	32	36.9	680
3/4	KRP12	29	10	33	38.1	680
1	KRP16	33	12	41	47.4	500
1-1/4	KRP20	34	14	50	57.8	500
1-1/2	KRP24	41	15	55	63.5	500
2	KRP32	47	17	70	80.8	500

\* Derate maximum working pressure by 50% for high pressure gas systems.