

316 Stainless Steel Twin Ferrule Imperial Tube Fittings

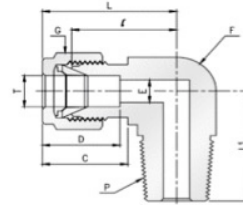

Male Elbows

Male Thread BSPT



PART NO	T in	P (BSPT)	E min	F	G	D	C	I	L	L1
ME-250-125RT	1/4	1/8	4.82	1/2	9/16	15.24	17.78	19.10	26.47	19.10
ME-250-250RT	1/4	1/4	4.82	1/2	9/16	15.24	17.78	19.81	27.18	23.87
ME-250-375RT	1/4	3/8	4.82	11/16	9/16	15.24	17.78	22.35	29.71	28.40
ME-250-500RT	1/4	1/2	4.82	13/16	9/16	15.24	17.78	24.60	31.97	35.10
ME-312-250RT	5/16	1/4	6.35	9/16	5/8	16.25	18.54	22.40	29.77	24.50
ME-375-250RT	3/8	1/4	7.11	5/8	11/16	16.76	19.30	23.11	30.48	25.40
ME-375-375RT	3/8	3/8	7.11	11/16	11/16	16.76	19.30	23.87	31.24	28.44