

# Straight Coupling (Metric)

## Benefits:

- Leak free o-ring seal
- Safe joint every time
- Low tightening torque and clamping force rises with the internal pressure.
- Low installed cost, no welding (so inert gas purging, NDT and excessive flushing are not required), minimal tube preparation and no special assembly equipment required.
- Demountable and reusable, can be used with most tube materials.

## Features:

Body – mild steel, stainless steel or cupro-nickel.  
Compatible with most fluids and environments. Locates o-ring and tube.

O-ring – nitrile, FPM (Viton), EP or FEP encapsulated FPM. Compatible with most fluids. Highly resistant to leakage even under severe vibration, pressure pulsation and temperature cycling. Provides diametric seal between tube OD and body cavity.

Nut – mild steel, stainless steel or cupro-nickel.  
Compatible with most environments. Closes split collet and retains sealing mechanism.

Back-up washer – mild steel, stainless steel, or cupro-nickel. Provides additional support for the tube and locates the o-ring.

Split collet – mild steel, stainless steel or cupro-nickel.  
Clamping force rises with pressure. Large clamping area ensures minimal deformation of the tube. Retains tube in position.

- 3:1 safety factor
- Derate by 50% for high pressure gas systems
- Pressure ratings based on the tube OD tolerance to BS3602 and DIN2391C

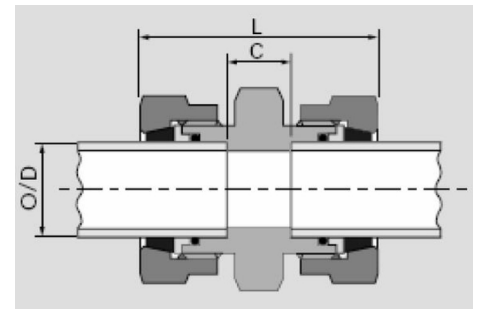

 **Working Temperature:**  
Nitrile: -40°C to +100°C  
Viton: -20°C to +150°C

 **Maximum Working Pressure:**  
6mm to 22mm: 680 bar  
25mm to 50mm: 500 bar

**All fittings also available in the following materials upon request:**

- Stainless steel
- Cupro-nickel

**Seals available on request:**

- EP (ethylene propylene)
- FEP encapsulated FPM

All fittings supplied with Nitrile seals as standard.

Primary Item No	O/D	Part No	C mm	L1 mm	Nut A/F mm	Body A/F mm	*Max WP Bar
5011907	6	KRAM6CR	14	44	16	14	680
5011960	8	KRAM8CR	14	44	17	17	680
5011459	10	KRAM10CR	10	54	27	27	680
5011534	12	KRAM12CR	10	54	27	27	680
5011609	16	KRAM16CR	11	57	32	27	680
5011667	20	KRAM20CR	13	73	41	36	680
5011696	22	KRAM22CR	13	73	41	41	680
5011733	25	KRAM25CR	17	76	46	41	500
5011786	30	KRAM30CR	22	89	50	46	500
5011827	38	KRAM38CR	29	105	60	55	500
5011860	50	KRAM50CR	37	137	80	80	500

\*Derate maximum working pressure by 50% for high pressure gas systems.