

# Reducing Nut Adaptors

## Benefits:

- Leak free o-ring seal
- Safe joint every time
- Low tightening torque and clamping force rises with the internal pressure.
- Low installed cost, no welding (so inert gas purging, NDT and excessive flushing are not required), minimal tube preparation and no special assembly equipment required.
- Demountable and reusable, can be used with most tube materials.

## Features:

Body- mild steel, compatible with most fluids and environments. Locates O'ring and tube.

O ring- nitrile, compatible with most fluids, highly resistant to leakage even under severe vibration, pressure pulsation and temperature cycling. Provides diametric seal between the O/D and body cavity.

Nut- mild steel, compatible with environments. Closes split collet and retains sealing mechanism.

Back-up washer- mild steel. Provides additional support for the tube and locates the O ring.

Split collet- mild steel. Clamping force rises with pressure. Large clamping area ensures minimal deformation of the tube. Retains tube in position.

## All fittings also available in the following materials upon request:

- Stainless steel
- Cupro-nickel

## Seals available on request:

- EP (ethylene propylene)
- FEP encapsulated FPM

All fittings supplied with Nitrile seals as standard.

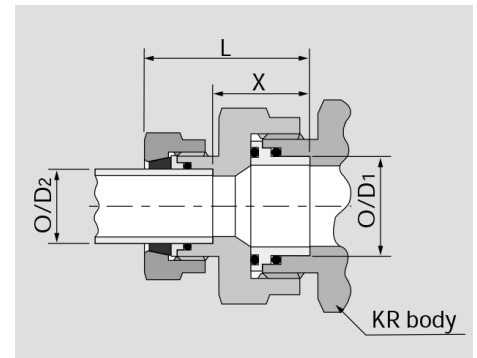
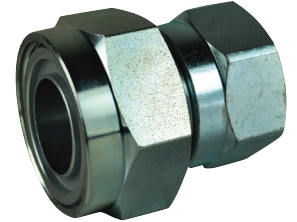

| Tube x Female |       |       |        |
|---------------|-------|-------|--------|
| 0459          | OD mm | OD mm | £      |
| KRAM10-M6RNR  | 10    | 6     | 17.70  |
| KRAM10-M8RNR  | 10    | 8     | 17.90  |
| KRAM12-M8RNR  | 12    | 8     | 15.55  |
| KRAM12-M10RNR | 12    | 10    | 17.90  |
| KRAM16-M8RNR  | 16    | 8     | 16.85  |
| KRAM16-M12RNR | 16    | 12    | 16.70  |
| KRAM20-M10RNR | 20    | 10    | 20.95  |
| KRAM20-M12RNR | 20    | 12    | 20.55  |
| KRAM20-M16RNR | 20    | 16    | 20.35  |
| KRAM25-M12RNR | 25    | 12    | 30.90  |
| KRAM25-M16RNR | 25    | 16    | 29.35  |
| KRAM25-M20RNR | 25    | 20    | 29.00  |
| KRAM30-M25RNR | 30    | 25    | 30.40  |
| KRAM38-M20RNR | 38    | 20    | 65.30  |
| KRAM38-M25RNR | 38    | 25    | 47.70  |
| KRAM38-M30RNR | 38    | 30    | 55.20  |
| KRAM50-M25RNR | 50    | 25    | 53.05  |
| KRAM50-M30RNR | 50    | 30    | 154.15 |
| KRAM50-M38RNR | 50    | 38    | 89.15  |

| O/D mm |    | Part No     | Dimensions - mm |    | Nut |    |
|--------|----|-------------|-----------------|----|-----|----|
| 1      | 2  |             | L               | X  | 1   | 2  |
| 8      | 6  | AM8-M6RNR   | 35              | 18 | 17  | 16 |
| 10     | 8  | AM10-M8RNR  | 39              | 24 | 17  | 27 |
| 10     | 6  | AM10-M6RNR  | 39              | 24 | 16  | 27 |
| 12     | 10 | AM12-M10RNR | 43              | 21 | 27  | 27 |
| 12     | 8  | AM12-M8RNR  | 39              | 24 | 17  | 27 |
| 12     | 6  | AM12-M6RNR  | 39              | 24 | 16  | 27 |
| 16     | 12 | AM16-M12RNR | 43              | 21 | 27  | 32 |
| 16     | 10 | AM16-M10RNR | 43              | 21 | 27  | 32 |
| 16     | 8  | AM16-M8RNR  | 40              | 25 | 17  | 32 |
| 16     | 6  | AM16-M6RNR  | 40              | 25 | 16  | 32 |
| 20     | 16 | AM20-M16RNR | 52              | 28 | 32  | 41 |
| 20     | 12 | AM20-M12RNR | 50              | 28 | 27  | 41 |
| 20     | 10 | AM20-M10RNR | 50              | 28 | 27  | 41 |
| 25     | 20 | AM25-M20RNR | 58              | 28 | 41  | 46 |
| 25     | 16 | AM25-M16RNR | 53              | 29 | 32  | 46 |
| 25     | 12 | AM25-M12RNR | 51              | 29 | 27  | 46 |
| 30     | 25 | AM30-M25RNR | 61              | 29 | 46  | 50 |
| 30     | 20 | AM30-M20RNR | 58              | 28 | 41  | 50 |
| 30     | 16 | AM30-M16RNR | 53              | 29 | 32  | 50 |
| 38     | 30 | AM38-M30RNR | 70              | 36 | 50  | 60 |
| 38     | 25 | AM38-M25RNR | 67              | 36 | 46  | 60 |
| 38     | 20 | AM38-M20RNR | 66              | 36 | 41  | 60 |
| 50     | 38 | AM50-M38RNR | 86              | 48 | 60  | 80 |
| 50     | 30 | AM50-M30RNR | 82              | 49 | 50  | 80 |
| 50     | 25 | AM50-M25RNR | 79              | 49 | 46  | 80 |