



Hydraulic Hose

Constant pressure

M6K

MEGASYS

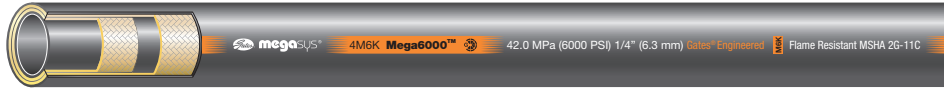

↔			⊘		💡		👤		👤		📊	📏
-size	DN	"	"	mm	PSI	MPa	PSI	MPa	mm	kg/100m	REF.	
-4	6	1/4	0.58	14.9	6000	42.0	24000	168.0	50	35	4M6K	

RECOMMENDED FOR	High pressure hydraulic applications. Easy to route and to install in tight areas.
TUBE	NBR (Nitrile) based.
REINFORCEMENT	Two braids of high tensile steel wire.
COVER	NBR/PVC based. MSHA approved.
TEMPERATURE RANGE	-40°C to +100°C constant and +121°C intermittent. For water emulsions, etc. see page 86.
STANDARDS	Gates proprietary. Meets or exceeds EN 857 2SC and ISO 11237 performance requirements.
COUPLINGS	MegaCrimp®.
TYPE APPROVALS	DNV, GL, LR, BV and MOD.
CHARACTERISTICS/BENEFITS	70% of EN 857 2SC and 50% of EN 853 2SN bend radius at rated working pressure. Superior flex impulse performance: tested to 600,000 impulse cycles. Lightweight. M6K hose is compatible with biodegradable hydraulic fluids like synthetic esters, polyglycols and vegetable oils as well as petroleum-based fluids.



Hydraulic Hose

Constant pressure

M5K

MEGASYS



-size	Size			Pressure		Burst Pressure		mm	kg/100m	REF.
	DN	"	"	PSI	MPa	PSI	MPa			
-4	6	1/4	0.54	5000	35.0	20000	140.0	50	30	4M5K
-5	8	5/16	0.61	5000	35.0	20000	140.0	55	34	5M5K
-6	10	3/8	0.69	5000	35.0	20000	140.0	65	41	6M5K
-8	12	1/2	0.86	5000	35.0	20000	140.0	90	66	8M5K

RECOMMENDED FOR

High pressure hydraulic applications. Easy to route and to install in tight areas.

TUBE

NBR (Nitrile) based.

REINFORCEMENT

Two braids of high tensile steel wire.

COVER

NBR/PVC based. MSHA approved.

TEMPERATURE RANGE

-40°C to +100°C constant and +121°C intermittent. For water emulsions, etc. see page 86.

STANDARDS

Gates proprietary. Meets or exceeds EN 857 2SC and ISO 11237 performance requirements.

COUPLINGS

MegaCrimp®.

TYPE APPROVALS

DNV, GL, LR, BV and MOD.

CHARACTERISTICS/BENEFITS

70% of EN 857 2SC and 50% of EN 853 2SN bend radius at rated working pressure.

Superior flex impulse performance: tested to 600,000 impulse cycles.

Lightweight.

M5K hose is compatible with biodegradable hydraulic fluids like synthetic esters, polyglycols and vegetable oils as well as petroleum-based fluids.

OPTIONAL



M5K-MTF: the complete range of M5K is also available with the Gates special MegaTuff™ cover which offers 300 times the abrasion resistance of the standard M5K cover as per ISO 6945, superior ozone and weathering resistance. M5K-MTF can also be used for in-oil (submersible) applications, please consult Gates Product Application Engineers for more info.

IMPORTANT



Please consult Gates Product Application Engineers for use of MegaTuff™ hose in reverse bending applications or for constant bending at minimum bend radius.



Hydraulic Hose

Constant pressure

M4K

MEGASYS

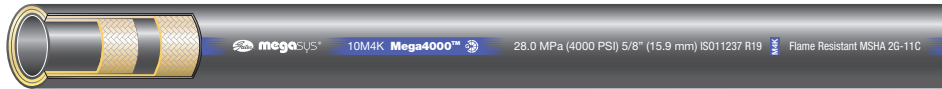

-size	↔		⊘		⊙		✂		R		kg	REF.
	DN	"	"	mm	PSI	MPa	PSI	MPa	mm	kg/100m		
-4	6	1/4	0.54	13.7	4000	28.0	16000	112.0	50	33	4M4K	
-5	8	5/16	0.61	15.4	4000	28.0	16000	112.0	55	34	5M4K	
-6	10	3/8	0.69	17.5	4000	28.0	16000	112.0	65	46	6M4K	
-8	12	1/2	0.82	20.8	4000	28.0	16000	112.0	90	51	8M4K	
-10	16	5/8	0.98	25.0	4000	28.0	16000	112.0	100	74	10M4K	
-12	19	3/4	1.15	29.1	4000	28.0	16000	112.0	120	93	12M4K	

RECOMMENDED FOR TUBE High pressure hydraulic applications. Easy to route and to install in tight areas.
NBR (Nitrile) based.

REINFORCEMENT Two braids of high tensile steel wire.

COVER NBR/PVC based. MSHA approved.

TEMPERATURE RANGE -40°C to +100°C constant and +121°C intermittent. For water emulsions, etc. see page 86.

STANDARDS SAE 100R19. ISO 11237 R19. Meets or exceeds EN 857 2SC performance requirements.

COUPLINGS MegaCrimp®.

TYPE APPROVALS DNV, GL, LR, BV, ABS and MOD.

CHARACTERISTICS/BENEFITS 70% of EN 857 2SC and 50% of EN 853 2SN bend radius at rated working pressure.
Superior flex impulse performance: tested to 600,000 impulse cycles.
Lightweight.
Alternative to spiral hoses in high pressure lines where flexibility is required.
M4K hose is compatible with biodegradable hydraulic fluids like synthetic esters, polyglycols and vegetable oils as well as petroleum-based fluids.

OPTIONAL



M4K-MTF: the complete range of M4K is also available with the Gates special MegaTuff™ cover which offers 300 times the abrasion resistance of the standard M4K cover as per ISO 6945, superior ozone and weathering resistance. M4K-MTF can also be used for in-oil (submersible) applications, please consult Gates Product Application Engineers for more info.



M4K-XTF: the complete range of M4K is also available with the Gates special XtraTuff™ cover which offers 25 times the abrasion resistance of the standard M4K cover as per ISO 6945.



M4KH: for high-temperature applications, Gates recommends the M4KH hose range up to 121°C constant. Please refer to page 47.

IMPORTANT



Please consult Gates Product Application Engineers for use of MegaTuff™ hose in reverse bending applications or for constant bending at minimum bend radius.

Hydraulic Hose

Constant pressure

M3K

MEGASYS



-size	↔		⊘		⊙		🔥		Ⓜ		REF.
	DN	"	"	mm	PSI	MPa	PSI	MPa	mm	kg/100m	
-4	6	1/4	0.48	12.2	3250	22.5	13000	90.0	50	17	4M3K
-5	8	5/16	0.59	15.1	3250	22.5	13000	90.0	55	26	5M3K
-6	10	3/8	0.63	16.0	3250	22.5	13000	90.0	65	28	6M3K
-8	12	1/2	0.80	20.2	3250	22.5	13000	90.0	90	41	8M3K
-10	16	5/8	0.99	25.2	3250	22.5	13000	90.0	100	73	10M3K
-12	19	3/4	1.14	29.0	3250	22.5	13000	90.0	120	91	12M3K
-16	25	1	1.48	37.7	3250	22.5	13000	90.0	150	155	16M3K

RECOMMENDED FOR

High pressure hydraulic applications. Easy to route and to install in tight areas.

TUBE

NBR (Nitrile) based.

REINFORCEMENT

-4 to -8: one braid of high tensile steel wire; -10 to -16: two braids of high tensile steel wire.

COVER

NBR/PVC based. MSHA approved.

TEMPERATURE RANGE

-40°C to +100°C constant and +121°C intermittent. For water emulsions, etc. see page 86.

STANDARDS

SAE 100R17. ISO 11237 R17. Meets or exceeds EN 857 1SC/2SC performance requirements.

COUPLINGS

MegaCrimp®.

TYPE APPROVALS

DNV, GL, LR, BV, ABS and MOD.

CHARACTERISTICS/BENEFITS

70% of EN 857 1SC/2SC and 50% of EN 853 1SN/2SN bend radius at rated working pressure.

Exceeds working pressure requirements of R17.

Superior flex impulse performance: tested with MegaCrimp® to 600,000 impulse cycles.

Lightweight.

M3K hose is compatible with biodegradable hydraulic fluids like synthetic esters, polyglycols and vegetable oils as well as petroleum-based fluids.

OPTIONAL



M3K-MTF: the complete range of M3K is also available with the Gates special MegaTuff™ cover which offers 300 times the abrasion resistance of the standard M3K cover as per ISO 6945, superior ozone and weathering resistance. M3K-MTF can also be used for in-oil (submersible) applications, please consult Gates Product Application Engineers for more info.



M3K-XTF: the complete range of M3K is also available with the Gates special XtraTuff™ cover which offers 25 times the abrasion resistance of the standard M3K cover as per ISO 6945.



M3KH: for high-temperature applications, Gates recommends the M3KH hose range up to 121°C constant. Please refer to page 48.



Hydraulic Hose

Constant pressure

M3KDL-XTF

MEGASYS



↔			⊙		⊙		👤		📏		📊	📦
-size	DN	"	"	mm	PSI	MPa	PSI	MPa	mm	kg/100m	REF.	
-4	6	1/4	0.48	12.2	3000	21.0	12000	84.0	50	54	4M3KDL-XTF	
-6	10	3/8	0.63	16.0	3000	21.0	12000	84.0	65	55	6M3KDL-XTF	
-8	12	1/2	0.80	20.2	3000	21.0	12000	84.0	90	80	8M3KDL-XTF	

RECOMMENDED FOR

High pressure hydraulic applications. Easy to route and to install in tight areas.

TUBE

NBR (Nitrile) based.

REINFORCEMENT

One braid of high tensile steel wire

COVER

XtraTuff™. MSHA approved.

TEMPERATURE RANGE

-40°C to +100°C constant and +121°C intermittent. For water emulsions, etc. see page 86.

STANDARDS

SAE 100R17. ISO 11237 R17. Meets or exceeds EN 857 1SC performance requirements.

COUPLINGS

MegaCrimp®.

CHARACTERISTICS/BENEFITS

70% of EN 857 1SC and 50% of EN 853 1SN bend radius at rated working pressure.

Superior flex impulse performance: tested with MegaCrimp® to 600,000 impulse cycles.

Lightweight.

M3K hose is compatible with biodegradable hydraulic fluids like synthetic esters, polyglycols and vegetable oils as well as petroleum-based fluids.

Gates special XtraTuff™ cover which offers 25 times the abrasion resistance of the standard M3K cover as per ISO 6945.

IMPORTANT



Gates recommends minimum split length of 250 mm depending on the application. Do not expose hose reinforcement when splitting hoses.



Hydraulic Hose

Exceeds ISO/EN/SAE standard

CM2T

ISO 11237 2SC R16



-size	↔		⊘		💡		👉👈		👂	📊	REF.
	DN	"	"	mm	PSI	MPa	PSI	MPa	mm	kg/100m	
-4	6	1/4	0.55	14.1	5800	40.0	23200	160.0	50	31	CM2T04
-5	8	5/16	0.61	15.5	5000	35.0	20000	140.0	55	35	CM2T05
-6	10	3/8	0.70	17.7	4800	33.0	19200	132.0	65	42	CM2T06
-8	12	1/2	0.82	20.8	4000	27.5	16000	110.0	90	51	CM2T08
-10	16	5/8	0.97	24.6	3625	25.0	14500	100.0	100	70	CM2T10
-12	19	3/4	1.09	27.8	3100	21.5	12400	86.0	120	81	CM2T12
-16	25	1	1.41	35.8	2400	16.5	9600	66.0	150	115	CM2T16

RECOMMENDED FOR

High pressure hydraulic applications. Easy to route and to install in tight areas.

TUBE

NBR (Nitrile) based.

REINFORCEMENT

Two braids of high tensile steel wire.

COVER

SBR based.

TEMPERATURE RANGE

-40°C to +100°C constant and +121°C intermittent. For water emulsions, etc. see page 86.

STANDARDS

EN 857 2SC. ISO 11237 2SC R16. SAE 100R16.

COUPLINGS

MegaCrimp®.

TYPE APPROVALS

DNV, GL, LR and BV.

CHARACTERISTICS/BENEFITS

70% of EN 857 2SC.

Superior flex impulse performance.

Lightweight.

CM2T hose is compatible with biodegradable hydraulic fluids like synthetic esters, polyglycols and vegetable oils as well as petroleum-based fluids.

OPTIONAL



CM2T-MTF: the complete range of CM2T is also available with the Gates special MegaTuff™ cover which offers 300 times the abrasion resistance of the standard CM2T cover as per ISO 6945, superior ozone and weathering resistance. CM2T-MTF can also be used for in-oil (submersible) applications, please consult Gates Product Application Engineers for more info.

IMPORTANT



Please consult Gates Product Application Engineers for use of MegaTuff™ hose in reverse bending applications or for constant bending at minimum bend radius.



Hydraulic Hose

Exceeds ISO/EN/SAE standard

TH8

ISO 3949 R8

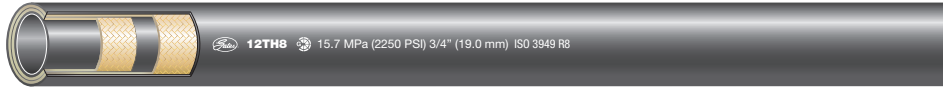

-size	↔		⊘		💡		🔥		👤		📊	📏
	DN	"	"	mm	PSI	MPa	PSI	MPa	mm	kg/100m	REF.	
-4	6	1/4	0.61	15.5	5000	35.0	20000	140.0	50	18	4TH8	
-6	10	3/8	0.76	19.1	4000	28.0	16000	112.0	65	31	6TH8	
-8	12	1/2	0.87	22.1	3500	24.5	14000	98.0	100	34	8TH8	
-12	19	3/4	1.13	28.7	2250	15.7	9000	63.0	165	38	12TH8	
-16	25	1	1.45	36.8	2000	14.0	8000	56.0	250	57	16TH8	

RECOMMENDED FOR

High pressure hydraulic applications, especially material handling equipment with mast and pulley systems like forklifts, aerial lifting, hydraulic boom cranes and many others.

TUBE

PA (Nylon) based.

REINFORCEMENT

Two fibre braids.

COVER

PU (Polyurethane) based. Black TH8 is perforated for use in general hydraulic and pneumatic service.

TEMPERATURE RANGE

-53°C to +93°C. Maximum of +70°C for water, water/oil emulsions and water glycol.

STANDARDS

SAE 100R8. ISO 3949 R8. EN 855 R8.

COUPLINGS

MegaCrimp®.



Hydraulic Hose

Exceeds ISO/EN/SAE standard

TH7

ISO 3949 R7



-size	↔		⊘		💡		🔥		👂		📊	
	DN	"	"	mm	PSI	MPa	PSI	MPa	mm	kg/100m	REF.	
-4	6	1/4	0.50	12.7	2750	19.2	11000	76.8	30	8	4TH7	
-5	8	5/16	0.56	14.7	2500	17.5	10000	70.0	45	10	5TH7	
-6	10	3/8	0.64	16.4	2250	15.7	9000	62.8	50	14	6TH7	
-8	12	1/2	0.80	20.3	2000	14.0	8000	56.0	75	21	8TH7	
-12	19	3/4	1.05	26.6	1250	8.7	5000	34.8	130	29	12TH7	
-16	25	1	1.32	33.4	1000	7.0	4000	28.0	250	40	16TH7	

RECOMMENDED FOR

High pressure hydraulic applications, especially material handling equipment with mast and pulley systems like forklifts, aerial lifting, hydraulic boom cranes and many others.

TUBE

PA (Nylon) based.

REINFORCEMENT

-4 to -6: spiralled synthetic fibre; -8 to -16: one fibre braid.

COVER

PU (Polyurethane) based. Black TH7 is perforated for use in general hydraulic and pneumatic service.

TEMPERATURE RANGE

-53°C to +93°C. Maximum of +70°C for water, water/oil emulsions and water glycol.

STANDARDS

SAE 100R7. ISO 3949 R7. EN 855 R7.

COUPLINGS

MegaCrimp®.

OPTIONAL



TH7NC: the complete range (-4 up to -16) is also available in a non-conductive version. This non-conductive hose has an orange polyurethane cover and is non-perforated for applications requiring electrical non-conductivity. TH7NC meets the SAE 100R7 Electrical Conductivity Test.



MegaCrimp®

NO-SKIVE FERRULES

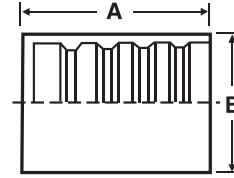

D			A	B	REF.
-size	DN	"	mm	mm	G
-24	40	1.1/2	75.8	70.0	24GSP1F-2
-32	50	2	90.0	83.5	32GSP1F-2

Note: Use GSP1F-4 ferrule for 4-spiral wire hose. For 6-spiral wire hose use 1-piece GSH-coupling.

BSP MBSPT

Male BSP taper.

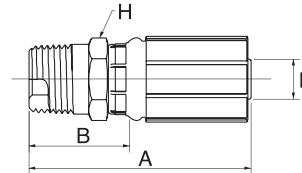

D			A	B	H	REF.	
-size	DN	"	mm	mm	mm	G	
-4	6	1/4	R 1/4" - 19 BSP	47.9	24.8	14.0	4G4MBSPT
-4	6	1/4	R 3/8" - 19 BSP	49.1	26.0	19.0	4G6MBSPT
-5	8	5/16	R 3/8" - 19 BSP	50.0	26.1	19.0	5G6MBSPT
-6	10	3/8	R 3/8" - 19 BSP	49.5	26.1	19.0	6G6MBSPT
-6	10	3/8	R 1/2" - 14 BSP	54.3	30.9	22.0	6G8MBSPT
-8	12	1/2	R 3/8" - 19 BSP	59.5	27.0	22.0	8G6MBSPT
-8	12	1/2	R 1/2" - 14 BSP	63.3	30.9	22.0	8G8MBSPT
-10	16	5/8	R 5/8" - 14 BSP	69.9	32.4	25.0	10G10MBSPT
-12	20	3/4	R 3/4" - 14 BSP	74.1	35.7	32.0	12G12MBSPT
-16	25	1	R 1" - 11 BSP	87.5	41.6	36.0	16G16MBSPT
-32	50	2	R 2" - 11 BSP	158.0	66.0	70.0	32GSP32MBSPT



MegaCrimp®

BSP FBSPORX

Female BSP 'O' ring swivel. 60° cone.

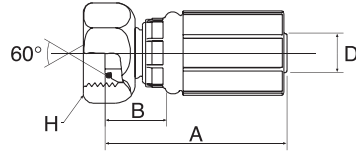

↻			🌀	↔			📏
D				A	B	H	REF.
-size	DN	"		mm	mm	mm	G
-4	6	1/4	G 1/8" - 28 BSP	41.1	18.0	14.0	4G2FBSPX (1)
-4	6	1/4	G 1/4" - 19 BSP	43.0	17.0	19.0	4G4FBSPORX
-4	6	1/4	G 3/8" - 19 BSP	44.0	18.0	22.0	4G6FBSPORX
-5	8	5/16	G 3/8" - 19 BSP	46.0	18.0	22.0	5G6FBSPORX
-5	8	5/16	G 1/2" - 14 BSP	46.0	18.0	27.0	5G8FBSPORX
-6	10	3/8	G 3/8" - 19 BSP	44.1	16.2	22.0	6G6FBSPORX
-6	10	3/8	G 1/2" - 14 BSP	45.8	17.9	27.0	6G8FBSPORX
-8	12	1/2	G 3/8" - 19 BSP	59.2	21.7	22.0	8G6FBSPORX
-8	12	1/2	G 1/2" - 14 BSP	55.5	17.8	27.0	8G8FBSPORX
-8	12	1/2	G 5/8" - 14 BSP	57.2	19.7	30.0	8G10FBSPORX
-8	12	1/2	G 3/4" - 14 BSP	59.0	21.5	32.0	8G12FBSPORX
-10	16	5/8	G 5/8" - 14 BSP	56.6	19.1	30.0	10G10FBSPORX
-10	16	5/8	G 3/4" - 14 BSP	59.0	21.5	32.0	10G12FBSPORX
-12	20	3/4	G 3/4" - 14 BSP	71.0	20.0	32.0	12G12FBSPORX
-12	20	3/4	G 1" - 11 BSP	73.6	22.6	41.0	12G16FBSPORX
-16	25	1	G 3/4" - 14 BSP	82.7	25.9	32.0	16G12FBSPORX
-16	25	1	G 1" - 11 BSP	83.8	27.0	41.0	16G16FBSPORX
-20	32	1.1/4	G 1.1/4" - 11 BSP	88.5	29.5	50.0	20G20FBSPORX
-24	40	1.1/2	G 1.1/2" - 11 BSP	125.0	51.3	55.0	24GSP24FBSPORX
-32	50	2	G 2" - 11 BSP	152.0	60.0	70.0	32GSP32FBSPORX

(1) without 'O' ring.



MegaCrimp®

BSP FBSPORX45

Female BSP 'O' ring swivel. 60° cone. 45° swept elbow.
Drop dimensions meet ISO 12151-6.

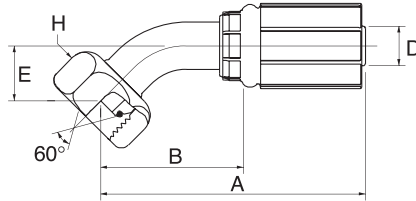

D				A	B	E	H	REF.
-size	DN	"		mm	mm	mm	mm	G
-4	6	1/4	G 1/4" - 19 BSP	57.1	31.1	11.5	19.0	4G4FBSPORX45
-4	6	1/4	G 3/8" - 19 BSP	63.2	37.1	17.7	22.0	4G6FBSPORX45
-5	8	5/16	G 3/8" - 19 BSP	66.6	38.6	16.8	22.0	5G6FBSPORX45
-6	10	3/8	G 3/8" - 19 BSP	66.9	39.0	15.2	22.0	6G6FBSPORX45
-6	10	3/8	G 1/2" - 14 BSP	71.0	43.0	19.3	27.0	6G8FBSPORX45
-8	12	1/2	G 1/2" - 14 BSP	81.3	43.9	17.0	27.0	8G8FBSPORX45
-8	12	1/2	G 5/8" - 14 BSP	91.0	53.5	23.0	30.0	8G10FBSPORX45
-10	16	5/8	G 5/8" - 14 BSP	89.6	52.1	21.3	30.0	10G10FBSPORX45
-10	16	5/8	G 3/4" - 14 BSP	99.5	62.0	31.2	32.0	10G12FBSPORX45
-12	20	3/4	G 3/4" - 14 BSP	115.4	64.4	28.3	32.0	12G12FBSPORX45
-16	25	1	G 1" - 11 BSP	135.6	78.8	30.9	41.0	16G16FBSPORX45
-20	32	1.1/4	G 1.1/4" - 11 BSP	139.6	93.4	37.5	50.0	20G20FBSPORX45
-24	40	1.1/2	G 1.1/2" - 11 BSP	214.5	140.8	49.7	55.0	24GSP24FBSPORX45
-32	50	2	G 2" - 11 BSP	276.1	184.1	62.3	70.0	32GSP32FBSPORX45



MegaCrimp®

BSP FBSPORX90

Female BSP 'O' ring swivel. 60° cone. 90° swept elbow.
Drop dimensions meet ISO 12151-6.

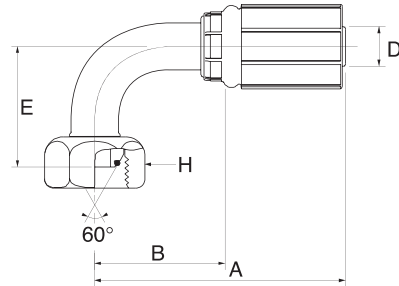

D				A	B	E	H	REF.
-size	DN	"		mm	mm	mm	mm	G
-4	6	1/4	G 1/4" - 19 BSP	52.5	26.5	23.3	19.0	4G4FBSPORX90
-4	6	1/4	G 3/8" - 19 BSP	50.6	24.3	32.0	22.0	4G6FBSPORX90
-5	8	5/16	G 3/8" - 19 BSP	58.0	30.0	32.0	22.0	5G6FBSPORX90
-6	10	3/8	G 3/8" - 19 BSP	61.9	34.0	32.0	22.0	6G6FBSPORX90
-6	10	3/8	G 1/2" - 14 BSP	60.1	32.2	37.5	27.0	6G8FBSPORX90
-8	12	1/2	G 1/2" - 14 BSP	78.0	40.5	37.3	27.0	8G8FBSPORX90
-8	12	1/2	G 5/8" - 14 BSP	81.5	44.0	46.0	30.0	8G10FBSPORX90
-10	16	5/8	G 5/8" - 14 BSP	84.1	46.6	46.0	30.0	10G10FBSPORX90
-10	16	5/8	G 3/4" - 14 BSP	84.1	46.6	60.0	32.0	10G12FBSPORX90
-12	20	3/4	G 3/4" - 14 BSP	107.0	56.0	60.0	32.0	12G12FBSPORX90
-12	20	3/4	G 1" - 11 BSP	112.2	61.2	70.0	41.0	12G16FBSPORX90
-16	25	1	G 3/4" - 14 BSP	108.8	52.0	54.1	32.0	16G12FBSPORX90
-16	25	1	G 1" - 11 BSP	131.1	74.3	70.0	41.0	16G16FBSPORX90
-16	25	1	G 1.1/4" - 11 BSP	131.1	74.3	80.0	50.0	16G20FBSPORX90
-20	32	1.1/4	G 1.1/4" - 11 BSP	129.1	82.8	80.0	50.0	20G20FBSPORX90
-24	40	1.1/2	G 1.1/2" - 11 BSP	194.6	120.9	100.0	55.0	24GSP24FBSPORX90
-32	50	2	G 2" - 11 BSP	254.7	162.7	129.1	70.0	32GSP32FBSPORX90



MegaCrimp®

BSP FBSPORX90BL

Female BSP 'O' ring swivel. 60° cone. 90° block elbow.

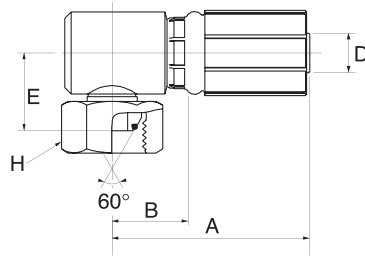

D				A	B	E	H	REF.
-size	DN	"		mm	mm	mm	mm	G
-4	6	1/4	G 1/4" - 19 BSP	44.2	18.2	18.0	19.0	4G4FBSPORX90BL
-4	6	1/4	G 3/8" - 19 BSP	46.0	20.0	21.5	22.0	4G6FBSPORX90BL
-6	10	3/8	G 3/8" - 19 BSP	47.9	20.0	21.5	22.0	6G6FBSPORX90BL
-6	10	3/8	G 1/2" - 14 BSP	51.4	23.5	24.0	27.0	6G8FBSPORX90BL
-8	12	1/2	G 1/2" - 14 BSP	55.9	23.5	24.0	27.0	8G8FBSPORX90BL
-8	12	1/2	G 5/8" - 14 BSP	55.9	23.5	25.2	30.0	8G10FBSPORX90BL
-10	16	5/8	G 5/8" - 14 BSP	62.4	24.9	27.6	30.0	10G10FBSPORX90BL
-12	20	3/4	G 3/4" - 14 BSP	78.0	27.0	34.7	32.0	12G12FBSPORX90BL
-16	25	1	G 3/4" - 14 BSP	86.2	29.4	37.8	32.0	16G12FBSPORX90BL
-16	25	1	G 1" - 11 BSP	80.5	34.6	36.1	41.0	16G16FBSPORX90BL



MegaCrimp®

BSP MBSPP

Male BSP parallel. 60° inverted cone.

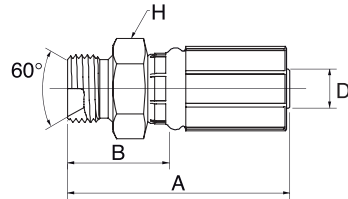

↻			🌀	↔			📏
D				A	B	H	REF.
-size	DN	"		mm	mm	mm	G
-4	6	1/4	G 1/4" - 19 BSP	51.5	25.8	19.0	4G4MBSPP
-4	6	1/4	G 3/8" - 19 BSP	51.8	25.8	22.0	4G6MBSPP
-4	6	1/4	G 1/2" - 14 BSP	59.5	33.5	27.0	4G8MBSPP
-5	8	5/16	G 1/4" - 19 BSP	53.5	25.5	19.0	5G4MBSPP
-5	8	5/16	G 3/8" - 19 BSP	53.8	25.8	22.0	5G6MBSPP
-6	10	3/8	G 1/4" - 19 BSP	52.0	24.1	19.0	6G4MBSPP
-6	10	3/8	G 3/8" - 19 BSP	55.0	27.1	22.0	6G6MBSPP
-6	10	3/8	G 1/2" - 14 BSP	60.0	32.1	27.0	6G8MBSPP
-8	12	1/2	G 3/8" - 19 BSP	63.5	26.0	22.0	8G6MBSPP
-8	12	1/2	G 1/2" - 14 BSP	69.0	31.5	27.0	8G8MBSPP
-8	12	1/2	G 5/8" - 14 BSP	71.0	33.5	30.0	8G10MBSPP
-10	16	5/8	G 5/8" - 14 BSP	73.5	36.0	30.0	10G10MBSPP
-10	16	5/8	G 3/4" - 14 BSP	71.5	34.0	32.0	10G12MBSPP
-12	20	3/4	G 3/4" - 14 BSP	85.0	34.0	32.0	12G12MBSPP
-16	25	1	G 1" - 11 BSP	101.0	44.2	41.0	16G16MBSPP
-20	32	1.1/4	G 1" - 11 BSP	104.5	45.5	46.0	20G16MBSPP
-20	32	1.1/4	G 1.1/4" - 11 BSP	110.0	51.0	50.0	20G20MBSPP
-24	40	1.1/2	G 1.1/2" - 11 BSP	130.0	56.4	55.0	24GSP24MBSPP
-32	50	2	G 2" - 11 BSP	148.8	56.8	70.0	32GSP32MBSPP

BSP MBSPPBKHD

Male BSP parallel. 60° inverted cone (Bulkhead).

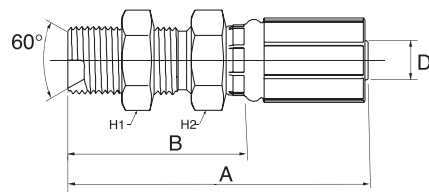

↻			🌀	↔				📏
D				A	B	H1	H2	REF.
-size	DN	"		mm	mm	mm	mm	G
-4	6	1/4	G 1/4" - 19 BSP	68.0	42.0	19.0	19.0	4G4MBSPPBKHD
-6	10	3/8	G 3/8" - 19 BSP	74.0	46.1	22.0	22.0	6G6MBSPPBKHD
-8	12	1/2	G 1/2" - 14 BSP	88.5	51.0	27.0	27.0	8G8MBSPPBKHD
-10	16	5/8	G 5/8" - 14 BSP	90.5	53.0	30.0	30.0	10G10MBSPPBKHD
-12	20	3/4	G 3/4" - 14 BSP	104.0	53.0	32.0	32.0	12G12MBSPPBKHD
-16	25	1	G 1" - 11 BSP	121.2	64.4	41.0	41.0	16G16MBSPPBKHD



MegaCrimp®

BSP FBFFX

Female BSP flat face swivel.

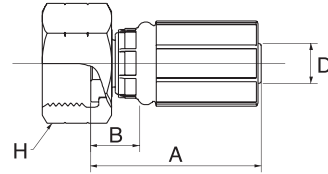

↔			🌀	↔	🌀		
D				A	B	H	REF.
-size	DN	"		mm	mm	mm	G
-5	8	5/16	G 1/2" - 14 BSP	45.5	17.5	27.0	5G8FBFFX
-6	10	3/8	G 3/8" - 19 BSP	46.0	18.1	22.0	6G6FBFFX
-6	10	3/8	G 1/2" - 14 BSP	45.5	17.6	27.0	6G8FBFFX
-8	12	1/2	G 1/2" - 14 BSP	55.5	18.0	27.0	8G8FBFFX
-8	12	1/2	G 5/8" - 14 BSP	56.0	18.5	30.0	8G10FBFFX
-8	12	1/2	G 3/4" - 14 BSP	52.5	15.0	32.0	8G12FBFFX
-10	16	5/8	G 3/4" - 14 BSP	52.5	15.0	32.0	10G12FBFFX
-12	20	3/4	G 3/4" - 14 BSP	68.5	17.5	32.0	12G12FBFFX

BSP BSPBJ

BSP banjo.

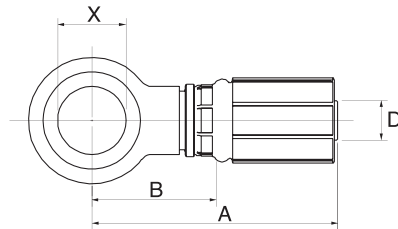

↔			🌀	↔	🌀		
D				A	B	X	REF.
-size	DN	"		mm	mm	mm	G
-4	6	1/4	1/4" - BSP	56.3	30.3	13.2	4G4BSPBJ
-4	6	1/4	3/8" - BSP	58.3	32.3	16.8	4G6BSPBJ
-6	10	3/8	1/4" - BSP	58.5	30.6	13.2	6G4BSPBJ
-6	10	3/8	3/8" - BSP	60.3	32.4	16.8	6G6BSPBJ
-6	10	3/8	1/2" - BSP	62.7	34.8	21.0	6G8BSPBJ
-8	12	1/2	1/2" - BSP	75.7	38.2	21.0	8G8BSPBJ
-12	20	3/4	3/4" - BSP	94.7	43.7	26.5	12G12BSPBJ

-4 to -12 size are 20.0 MPa (2900 psi).



MegaCrimp®

JIC 37° FJX

Female JIC swivel. 37° inverted cone.

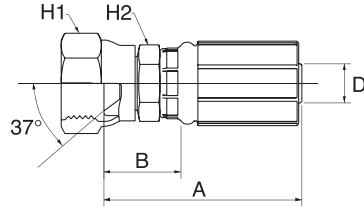

D				A	B	H1	H2	REF.
-size	DN	"		mm	mm	mm	mm	G
-4	6	1/4	7/16" - 20 UNF	47.6	21.3	14.0	15.0	4G4FJX
-4	6	1/4	1/2" - 20 UNF	49.2	22.9	17.0	15.0	4G5FJX
-4	6	1/4	9/16" - 18 UNF	51.1	25.1	19.0	15.0	4G6FJX
-5	8	5/16	1/2" - 20 UNF	53.0	25.0	17.0	17.0	5G5FJX
-5	8	5/16	9/16" - 18 UNF	55.1	27.1	19.0	17.0	5G6FJX
-6	10	3/8	7/16" - 20 UNF	44.5	16.6	14.0	15.9	6G4FJX
-6	10	3/8	1/2" - 20 UNF	45.0	17.1	17.0	17.0	6G5FJX
-6	10	3/8	9/16" - 18 UNF	53.0	24.2	19.0	18.0	6G6FJX
-6	10	3/8	3/4" - 16 UNF	56.3	27.5	24.0	18.0	6G8FJX
-6	10	3/8	7/8" - 14 UNF	56.3	27.5	27.0	18.0	6G10FJX
-8	12	1/2	9/16" - 18 UNF	57.0	19.5	19.0	20.6	8G6FJX
-8	12	1/2	3/4" - 16 UNF	62.8	27.3	24.0	22.0	8G8FJX
-8	12	1/2	7/8" - 14 UNF	62.8	27.3	27.0	22.0	8G10FJX
-8	12	1/2	1.1/16" - 12 UN	62.8	27.3	32.0	22.0	8G12FJX
-10	16	5/8	3/4" - 16 UNF	61.0	23.5	24.0	24.0	10G8FJX
-10	16	5/8	7/8" - 14 UNF	66.0	28.5	27.0	24.0	10G10FJX
-10	16	5/8	1.1/16" - 12 UN	66.4	28.9	31.8	24.0	10G12FJX
-10	16	5/8	1.3/16" - 12 UN	70.0	32.5	36.0	24.0	10G14FJX
-12	20	3/4	7/8" - 14 UNF	122.0	71.0	27.0	27.0	12G10FJX
-12	20	3/4	1.1/16" - 12 UN	80.0	29.0	32.0	30.0	12G12FJX
-12	20	3/4	1.3/16" - 12 UN	80.8	29.8	36.0	30.0	12G14FJX
-12	20	3/4	1.5/16" - 12 UN	81.1	30.1	41.0	30.0	12G16FJX
-16	25	1	1.1/16" - 12 UN	86.0	29.2	31.8	34.9	16G12FJX
-16	25	1	1.3/16" - 12 UN	86.0	29.2	34.9	34.9	16G14FJX
-16	25	1	1.5/16" - 12 UN	94.2	37.4	41.0	41.0	16G16FJX
-16	25	1	1.5/8" - 12 UN	93.0	36.2	50.8	39.7	16G20FJX
-20	32	1.1/4	1.5/8" - 12 UN	100.0	41.0	50.8	44.5	20G20FJX
-20	32	1.1/4	1.7/8" - 12 UN	103.5	44.5	57.2	47.6	20G24FJX
-24	40	1.1/2	1.7/8" - 12 UN	124.0	50.4	60.0	55.0	24GSP24FJX
-32	50	2	2.1/2" - 12 UN	148.0	56.0	75.0	65.0	32GSP32FJX



MegaCrimp®

JIC 37° FJX45S

Female JIC swivel. 37° inverted cone. 45° swept elbow. Short drop (-4 to -16 drop dimensions meet ISO 12151-5).

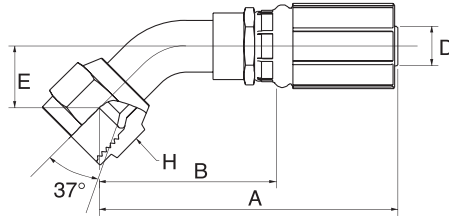

D				A	B	E	H	REF.
-size	DN	"		mm	mm	mm	mm	G
-4	6	1/4	7/16" - 20 UNF	69.7	43.7	10.0	14.0	4G4FJX45S
-4	6	1/4	1/2" - 20 UNF	65.8	39.7	11.0	17.0	4G5FJX45-011
-4	6	1/4	9/16" - 18 UNF	77.8	51.8	11.0	19.0	4G6FJX45S
-5	8	5/16	1/2" - 20 UNF	68.3	40.3	11.0	17.0	5G5FJX45-011
-5	8	5/16	9/16" - 18 UNF	72.4	44.4	11.0	19.0	5G6FJX45S
-6	10	3/8	7/16" - 20 UNF	72.7	44.8	10.0	14.0	6G4FJX45S
-6	10	3/8	9/16" - 18 UNF	77.5	49.6	11.0	19.0	6G6FJX45S
-6	10	3/8	3/4" - 16 UNF	89.1	61.6	15.0	24.0	6G8FJX45S
-8	12	1/2	3/4" - 16 UNF	86.9	49.5	15.0	24.0	8G8FJX45S
-8	12	1/2	7/8" - 14 UNF	96.8	59.4	16.0	27.0	8G10FJX45S
-10	16	5/8	7/8" - 14 UNF	96.4	59.0	16.0	27.0	10G10FJX45S
-10	16	5/8	1.1/16" - 12 UN	116.0	78.5	21.0	32.0	10G12FJX45S
-12	20	3/4	7/8" - 14 UNF	116.3	65.3	19.0	27.0	12G10FJX45S
-12	20	3/4	1.1/16" - 12 UN	129.2	78.2	21.0	32.0	12G12FJX45S
-12	20	3/4	1.5/16" - 12 UN	133.1	82.1	24.0	41.0	12G16FJX45S
-16	25	1	1.5/16" - 12 UN	144.3	87.5	24.0	41.0	16G16FJX45S
-20	32	1.1/4	1.5/8" - 12 UN	169.0	110.0	35.0	50.8	20G20FJX45
-24	40	1.1/2	1.7/8" - 12 UN	233.0	159.5	50.0	60.0	24GSP24FJX45-050
-32	50	2	2.1/2" - 12 UN	276.0	183.3	45.0	75.0	32GSP32FJX45



MegaCrimp®

JIC 37° FJX90S

Female JIC swivel. 37° inverted cone. 90° swept elbow.
Short drop (-4 to -16 drop dimensions meet ISO 12151-5).

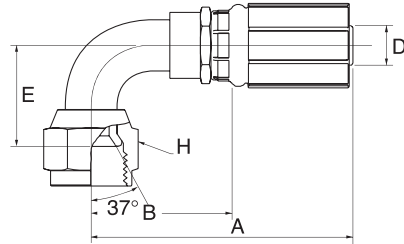

D				A	B	E	H	REF.
-size	DN	"		mm	mm	mm	mm	G
-4	6	1/4	7/16"-20 UNF	63.1	37.1	21.0	14.0	4G4FJX90S
-4	6	1/4	1/2"-20 UNF	62.2	36.2	23.0	17.0	4G5FJX90-023
-4	6	1/4	9/16"-18 UNF	70.5	44.4	23.0	19.0	4G6FJX90S
-5	8	5/16	9/16"-18 UNF	75.2	47.2	23.0	19.0	5G6FJX90S
-6	10	3/8	7/16"-20 UNF	66.1	38.2	21.0	14.0	6G4FJX90S
-6	10	3/8	9/16"-18 UNF	74.2	46.3	23.0	19.0	6G6FJX90S
-6	10	3/8	3/4"-16 UNF	82.6	54.7	29.0	24.0	6G8FJX90S
-8	12	1/2	9/16"-18 UNF	77.3	39.9	41.0	24.0	8G6FJX90S
-8	12	1/2	3/4"-16 UNF	81.0	43.5	29.0	24.0	8G8FJX90S
-8	12	1/2	7/8"-14 UNF	93.3	55.8	32.0	27.0	8G10FJX90S
-8	12	1/2	1.1/16"-12 UN	107.5	70.0	48.0	32.0	8G12FJX90S
-10	16	5/8	7/8"-14 UNF	89.0	51.5	36.0	27.0	10G10FJX90-036
-10	16	5/8	1.1/16"-12 UN	106.1	68.6	48.0	32.0	10G12FJX90S
-12	20	3/4	1.1/16"-12 UN	122.4	71.4	48.0	32.0	12G12FJX90S
-12	20	3/4	1.3/16"-12 UN	124.0	73.0	54.0	36.0	12G14FJX90-054
-12	20	3/4	1.5/16"-12 UN	132.7	81.7	56.0	41.0	12G16FJX90S
-16	25	1	1.5/16"-12 UN	145.6	88.8	56.0	41.0	16G16FJX90S
-16	25	1	1.5/8"-12 UN	167.0	110.2	75.0	50.8	16G20FJX90S



MegaCrimp®

JIC 37° FJX90M

Female JIC swivel. 37° inverted cone. 90° swept elbow.
Medium drop (-4 to -20 drop dimensions meet ISO 12151-5).

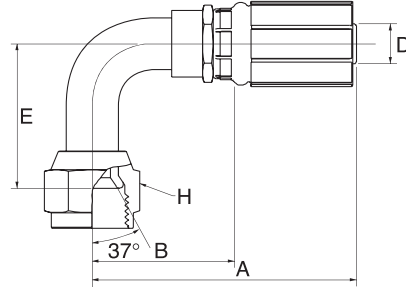

↔			🌀	↔				🌀
D				A	B	E	H	REF.
-size	DN	"		mm	mm	mm	mm	G
-4	6	1/4	7/16 - 20 UNF	63.2	37.1	32.0	14.0	4G4FJX90M
-4	6	1/4	1/2" - 20 UNF	57.2	31.2	32.0	17.0	4G5FJX90M
-4	6	1/4	9/16" - 18 UNF	64.9	38.9	38.0	19.0	4G6FJX90M
-5	8	5/16	1/2" - 20 UNF	56.0	28.0	28.7	15.9	5G5FJX90M
-5	8	5/16	9/16" - 18 UNF	76.0	48.0	38.0	19.0	5G6FJX90M
-6	10	3/8	9/16" - 18 UNF	74.2	46.3	38.0	19.0	6G6FJX90M
-6	10	3/8	3/4" - 16 UNF	84.1	56.2	41.0	24.0	6G8FJX90M
-6	10	3/8	7/8" - 14 UNF	82.5	54.6	47.0	27.0	6G10FJX90M
-8	12	1/2	3/4" - 16 UNF	77.3	39.9	41.0	24.0	8G8FJX90M
-8	12	1/2	7/8" - 14 UNF	93.3	55.8	47.0	27.0	8G10FJX90M
-10	16	5/8	7/8" - 14 UNF	93.4	55.9	47.0	27.0	10G10FJX90M
-10	16	5/8	1.1/16" - 12 UN	101.9	64.4	58.0	32.0	10G12FJX90M
-12	20	3/4	7/8" - 14 UNF	114.1	63.1	47.0	27.0	12G10FJX90M
-12	20	3/4	1.1/16" - 12 UN	122.4	71.4	58.0	32.0	12G12FJX90M
-16	25	1	1.5/16" - 12 UN	120.0	63.2	66.5	38.1	16G16FJX90M
-20	32	1.1/4	1.5/8" - 12 UN	138.0	79.0	88.9	50.8	20G20FJX90M
-24	40	1.1/2	1.7/8" - 12 UN	212.0	138.4	89.0	60.0	24GSP24FJX90-089
-32	50	2	2.1/2" - 12 UN	272.0	179.7	140.0	75.0	32GSP32FJX90



MegaCrimp®

JIC 37° FJX90L

Female JIC swivel. 37° inverted cone. 90° swept elbow.
Long drop (-4 to -20 drop dimensions meet ISO 12151-5).

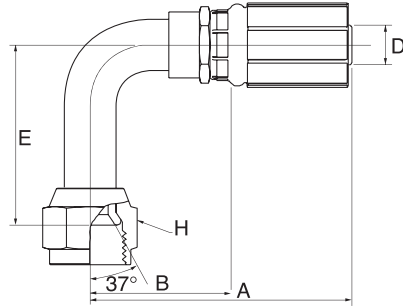

↔			🌀	↔				🌀
D				A	B	E	H	REF.
-size	DN	"		mm	mm	mm	mm	G
-4	6	1/4	7/16" - 20 UNF	63.1	37.1	46.0	14.0	4G4FJX90L
-4	6	1/4	1/2" - 20 UNF	57.2	31.2	46.0	17.0	4G5FJX90L
-4	6	1/4	9/16" - 18 UNF	69.3	43.2	54.0	19.0	4G6FJX90L
-6	10	3/8	7/16" - 20 UNF	60.2	32.3	46.0	14.0	6G4FJX90L
-6	10	3/8	9/16" - 18 UNF	74.2	46.3	54.0	19.0	6G6FJX90L
-6	10	3/8	3/4" - 16 UNF	84.5	56.6	64.0	24.0	6G8FJX90L
-8	12	1/2	3/4" - 16 UNF	77.3	39.9	64.0	24.0	8G8FJX90L
-8	12	1/2	7/8" - 14 UNF	93.3	55.8	70.0	27.0	8G10FJX90L
-10	16	5/8	7/8" - 14 UNF	85.9	48.4	70.0	27.0	10G10FJX90L
-10	16	5/8	1.1/16" - 12 UN	116.5	79.0	96.0	32.0	10G12FJX90L
-12	20	3/4	1.1/16" - 12 UN	122.4	71.4	96.0	32.0	12G12FJX90L
-12	20	3/4	1.3/16" - 12 UN	107.4	56.4	100.0	36.0	12G14FJX90-100
-16	25	1	1.5/16" - 12 UN	114.9	58.1	110.0	38.1	16G16FJX90L
-20	32	1.1/4	1.5/8" - 12 UN	158.0	99.0	129.0	50.8	20G20FJX90L



MegaCrimp®

JIC 37° MJ

Male JIC parallel. 37° cone.

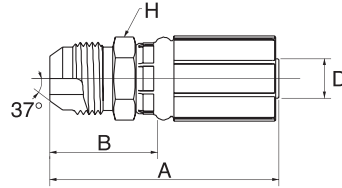

↔			🌀	↔			🌀
D				A	B	H	REF.
-size	DN	"		mm	mm	mm	G
-4	6	1/4	7/16" - 20 UNF	55.5	29.5	14.0	4G4MJ
-4	6	1/4	1/2" - 20 UNF	55.5	29.5	14.0	4G5MJ
-4	6	1/4	9/16" - 18 UNF	56.5	30.5	17.0	4G6MJ
-5	8	5/16	1/2" - 20 UNF	57.5	29.5	17.0	5G5MJ
-5	8	5/16	9/16" - 18 UNF	57.5	29.5	17.0	5G6MJ
-6	10	3/8	9/16" - 18 UNF	58.5	30.6	17.0	6G6MJ
-6	10	3/8	3/4" - 16 UNF	63.0	35.1	19.0	6G8MJ
-6	10	3/8	7/8" - 14 UNF	67.0	39.1	24.0	6G10MJ
-8	12	1/2	3/4" - 16 UNF	71.5	34.0	22.0	8G8MJ
-8	12	1/2	7/8" - 14 UNF	74.0	36.5	24.0	8G10MJ
-8	12	1/2	1.1/16" - 12 UN	81.0	43.5	27.0	8G12MJ
-10	16	5/8	3/4" - 16 UNF	74.5	37.0	24.0	10G8MJ
-10	16	5/8	7/8" - 14 UNF	77.0	39.5	24.0	10G10MJ
-10	16	5/8	1.1/16" - 12 UN	81.0	43.5	27.0	10G12MJ
-12	20	3/4	1.1/16" - 12 UN	94.5	43.5	27.0	12G12MJ
-12	20	3/4	1.3/16" - 12 UN	95.5	44.5	32.0	12G14MJ
-12	20	3/4	1.5/16" - 12 UN	96.0	45.0	36.0	12G16MJ
-16	25	1	1.5/16" - 12 UN	104.5	47.7	36.0	16G16MJ
-16	25	1	1.5/8" - 12 UN	109.0	52.2	44.5	16G20MJ
-20	32	1.1/4	1.5/8" - 12 UN	112.5	53.5	44.5	20G20MJ
-24	40	1.1/2	1.7/8" - 12 UN	130.0	56.4	50.0	24GSP24MJ
-32	50	2	2.1/2" - 12 UN	161.1	69.1	65.0	32GSP32MJ

JIS FJISX

Female Japanese swivel. 30° inverted cone. BSP thread.

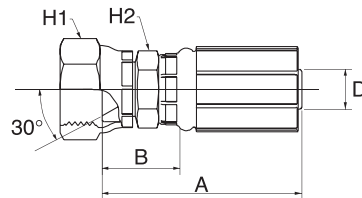

↔			🌀	↔				🌀
D				A	B	H1	H2	REF.
-size	DN	"		mm	mm	mm	mm	G
-4	6	1/4	G 1/4" - 19 BSP	47.0	21.0	19.1	19.1	4G4FJISX
-6	10	3/8	G 3/8" - 19 BSP	52.0	24.1	22.0	17.0	6G6FJISX
-8	12	1/2	G 1/2" - 14 BSP	67.9	30.4	27.0	22.0	8G8FJISX
-12	20	3/4	G 3/4" - 14 BSP	81.3	30.3	36.0	30.0	12G12FJISX
-16	25	1	G 1" - 11 BSP	94.0	37.2	41.0	41.0	16G16FJISX



MegaCrimp®

JIS FKX

Female Japanese swivel. 30° inverted cone. Metric thread.

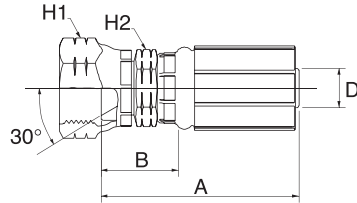

D				A B H1 H2				REF.
-size	DN	"		mm	mm	mm	mm	G
-4	6	1/4	M14 x 1.5	46.5	20.5	19.1	14.3	4G4FKX
-6	10	3/8	M18 x 1.5	52.0	24.1	22.2	17.5	6G6FKX
-8	12	1/2	M22 x 1.5	61.5	24.0	27.0	22.0	8G8FKX
-10	16	5/8	M24 x 1.5	63.5	26.0	32.0	24.0	10G10FKX
-12	20	3/4	M30 x 1.5	82.3	31.3	36.0	30.0	12G12FKX
-16	25	1	M33 x 1.5	92.5	35.7	41.3	34.9	16G16FKX
-20	32	1.1/4	M36 x 1.5	105.0	46.0	50.8	44.5	20G20FKX

SAE FFORX

Female SAE flat face 'O' ring swivel.

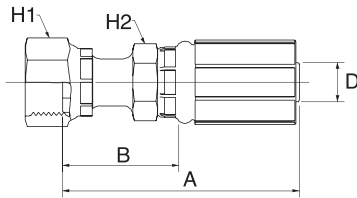

D				A B H1 H2				REF.
-size	DN	"		mm	mm	mm	mm	G
-4	6	1/4	9/16" - 18 UNF	52.7	26.7	17.0	15.0	4G4FFORX
-4	6	1/4	11/16" - 16 UN	51.1	25.1	22.0	15.0	4G6FFORX
-4	6	1/4	13/16" - 16 UN	50.5	24.5	24.0	15.0	4G8FFORX
-5	8	5/16	11/16" - 16 UN	61.5	33.5	22.0	17.0	5G6FFORX
-6	10	3/8	9/16" - 18 UNF	78.3	50.3	17.0	17.0	6G4FFORX
-6	10	3/8	11/16" - 16 UN	57.7	28.9	22.0	18.0	6G6FFORX
-6	10	3/8	13/16" - 16 UN	57.4	28.6	24.0	18.0	6G8FFORX
-6	10	3/8	13/16" - 16 UN	54.7	25.9	30.0	18.0	6G10FFORX
-8	12	1/2	11/16" - 16 UN	95.9	58.4	22.0	22.0	8G6FFORX
-8	12	1/2	13/16" - 16 UN	66.5	31.3	24.0	22.0	8G8FFORX
-8	12	1/2	1" - 14 UNS	70.0	34.8	30.0	22.0	8G10FFORX
-8	12	1/2	1.3/16" - 12 UN	71.5	36.3	36.0	22.0	8G12FFORX
-10	12	5/8	13/16" - 16 UN	97.2	59.7	24.0	24.0	10G8FFORX
-10	16	5/8	1" - 14 UNS	76.0	38.5	30.0	24.0	10G10FFORX
-10	16	5/8	1.3/16" - 12 UN	77.0	39.5	36.0	24.0	10G12FFORX
-12	20	3/4	1" - 14 UNS	95.1	44.1	30.0	30.0	12G10FFORX
-12	20	3/4	1.3/16" - 12 UN	92.8	41.8	36.0	30.0	12G12FFORX
-12	20	3/4	1.7/16" - 12 UN	88.3	37.3	41.0	30.0	12G16FFORX
-16	25	1	1.7/16" - 12 UN	110.0	53.2	41.3	41.0	16G16FFORX
-16	25	1	1.11/16" - 12 UN	104.5	47.7	47.6	41.0	16G20FFORX
-20	32	1.1/4	1.11/16" - 12 UN	117.5	58.5	47.6	50.0	20G20FFORX
-24	40	1.1/2	2" - 12 UN	137.0	63.4	60.0	55.0	24GSP24FFORX

Unless otherwise stated the coupling meets the pressure rating requirements of the respective international standard.



MegaCrimp®

SAE FFORX45S

Female SAE flat face 'O' ring swivel. 45° swept elbow.
Short drop (-4 to -20 drop dimensions meet ISO 12151-5).

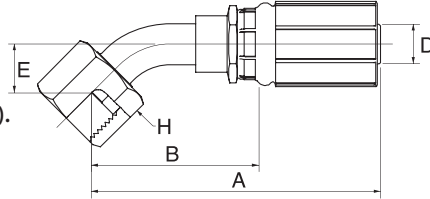

D			A	B	E	H	REF.			
-size	DN	"	mm	mm	mm	mm	G			
-4	6	1/4	9/16" - 18 UNF	65.2	39.2	10.0	17.0	4G4FFORX45S		
-4	6	1/4	11/16" - 16 UN	68.5	42.5	11.0	22.0	4G6FFORX45S		
-5	8	5/16	11/16" - 16 UN	69.4	41.4	11.0	22.0	5G6FFORX45S		
-6	10	3/8	9/16" - 18 UNF	66.1	38.1	10.0	17.0	6G4FFORX45S		
-6	10	3/8	11/16" - 16 UN	69.8	41.9	11.0	22.0	6G6FFORX45S		
-6	10	3/8	13/16" - 16 UN	85.2	57.3	15.0	24.0	6G8FFORX45S		
-8	12	1/2	11/16" - 16 UN	90.7	53.2	11.0	22.0	8G6FFORX45S		
-8	12	1/2	13/16" - 16 UN	89.0	51.6	15.0	24.0	8G8FFORX45S		
-8	12	1/2	1" - 14 UNS	101.0	63.5	16.0	30.0	8G10FFORX45S		
-8	12	1/2	1.3/16" - 12 UN	110.3	72.8	21.0	36.0	8G12FFORX45S		
-10	16	5/8	13/16" - 16 UN	96.8	59.3	15.0	24.0	10G8FFORX45S		
-10	16	5/8	1" - 14 UNS	100.5	63.0	16.0	30.0	10G10FFORX45S		
-10	16	5/8	1.3/16" - 12 UN	105.9	68.4	21.0	36.0	10G12FFORX45S		
-12	20	3/4	1" - 14 UNS	113.0	62.0	16.0	30.0	12G10FFORX45S		
-12	20	3/4	1.3/16" - 12 UN	118.4	67.4	21.0	36.0	12G12FFORX45S		
-12	20	3/4	1.7/16" - 12 UN	122.0	71.0	24.0	41.0	12G16FFORX45S		
-16	25	1	1.3/16" - 12 UN	132.5	75.7	21.0	36.0	16G12FFORX45S		
-16	25	1	1.7/16" - 12 UN	146.9	90.1	24.0	41.0	16G16FFORX45S		
-20	32	1.1/4	1.11/16" - 12 UN	158.0	99.0	25.0	50.0	20G20FFORX45S		



MegaCrimp®

SAE FFORX90S

Female SAE flat face 'O' ring swivel. 90° swept elbow.
Short drop (-4 to -20 drop dimensions meet ISO 12151-1).

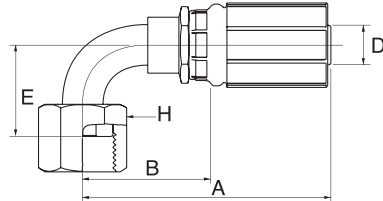

D				A	B	E	H	REF.
-size	DN	"		mm	mm	mm	mm	G
-4	6	1/4	9/16" - 18 UNF	60.2	34.4	21.0	17.0	4G4FFORX90S
-4	6	1/4	11/16" - 16 UN	63.4	37.4	23.0	22.0	4G6FFORX90S
-5	8	5/16	11/16" - 16 UN	72.0	44.0	23.0	22.0	5G6FFORX90S
-6	10	3/8	9/16" - 18 UNF	61.4	33.6	21.0	17.0	6G4FFORX90S
-6	10	3/8	11/16" - 16 UN	72.5	44.6	23.0	22.0	6G6FFORX90S
-6	10	3/8	13/16" - 16 UN	73.0	45.1	29.0	24.0	6G8FFORX90S
-8	12	1/2	11/16" - 16 UN	83.5	46.0	23.0	22.0	8G6FFORX90S
-8	12	1/2	13/16" - 16 UN	83.9	46.5	29.0	24.0	8G8FFORX90S
-8	12	1/2	1" - 14 UNS	92.9	55.4	32.0	30.0	8G10FFORX90S
-8	12	1/2	1.3/16" - 12 UN	102.9	65.4	48.0	36.0	8G12FFORX90S
-10	16	5/8	13/16" - 16 UN	92.4	54.9	29.0	24.0	10G8FFORX90S
-10	16	5/8	1" - 14 UNS	92.5	55.0	32.0	30.0	10G10FFORX90S
-10	16	5/8	1.3/16" - 12 UN	96.3	58.8	48.0	36.0	10G12FFORX90S
-12	20	3/4	1" - 14 UNS	104.0	53.0	32.0	30.0	12G10FFORX90S
-12	20	3/4	1.3/16" - 12 UN	109.0	58.0	48.0	36.0	12G12FFORX90S
-12	20	3/4	1.7/16" - 12 UN	128.5	77.5	56.0	41.0	12G16FFORX90S
-16	25	1	1.3/16" - 12 UN	129.4	72.6	48.0	36.0	16G12FFORX90S
-16	25	1	1.7/16" - 12 UN	129.9	73.1	56.0	41.0	16G16FFORX90S
-20	32	1.1/4	1.11/16" - 12 UN	150.0	91.0	64.0	50.0	20G20FFORX90S



MegaCrimp®

SAE FFORX90M

Female SAE flat face 'O' ring swivel. 90° swept elbow.
Medium drop (-4 to -20 drop dimensions meet ISO 12151-1).

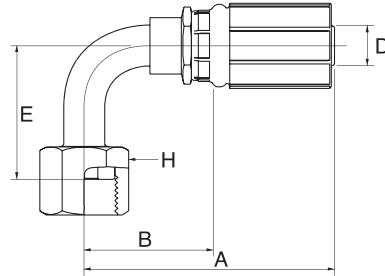

↔				↔				
D				A	B	E	H	REF.
-size	DN	"		mm	mm	mm	mm	G
-4	6	1/4	9/16" - 18 UNF	56.2	30.2	32.0	17.0	4G4FFORX90M
-4	6	1/4	11/16" - 16 UN	63.4	37.4	38.0	22.0	4G6FFORX90M
-6	10	3/8	11/16" - 16 UN	63.6	35.7	38.0	22.0	6G6FFORX90M
-6	10	3/8	13/16" - 16 UN	68.5	40.6	41.0	24.0	6G8FFORX90M
-8	12	1/2	13/16" - 16 UN	83.9	46.5	41.0	24.0	8G8FFORX90M
-8	12	1/2	1" - 14 UNS	93.2	55.7	47.0	30.0	8G10FFORX90M
-10	16	5/8	1" - 14 UNS	92.8	55.3	47.0	30.0	10G10FFORX90M
-12	20	3/4	1.3/16" - 12 UN	109.0	58.0	58.0	36.0	12G12FFORX90M
-16	25	1	1.7/16" - 12 UN	129.9	73.1	71.0	41.0	16G16FFORX90M
-16	25	1	1.11/16" - 12 UN	156.0	99.2	78.0	50.0	16G20FFORX90M
-20	32	1.1/4	1.11/16" - 12 UN	140.0	81.0	78.0	50.0	20G20FFORX90M



MegaCrimp®

SAE FFORX90L

Female SAE flat face 'O' ring swivel. 90° swept elbow.
Long drop (-4 to -20 drop dimensions meet ISO 12151-1).

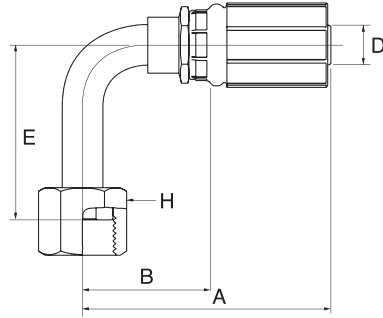

↻			🌀	↔				📏
D				A	B	E	H	REF.
-size	DN	"		mm	mm	mm	mm	G
-4	6	1/4	9/16" - 18 UNF	56.2	30.2	46.0	17.0	4G4FFORX90L
-4	6	1/4	11/16" - 16 UN	61.6	35.6	54.0	22.0	4G6FFORX90L
-4	6	1/4	13/16" - 16 UN	67.1	41.1	64.0	24.0	4G8FFORX90L
-6	10	3/8	11/16" - 16 UN	69.3	41.4	54.0	22.0	6G6FFORX90L
-6	10	3/8	13/16" - 16 UN	69.0	41.1	64.0	24.0	6G8FFORX90L
-8	12	1/2	13/16" - 16 UN	83.9	46.5	64.0	24.0	8G8FFORX90L
-8	12	1/2	1" - 14 UNS	90.6	53.1	70.0	30.0	8G10FFORX90L
-10	16	5/8	13/16" - 16 UN	92.4	54.9	64.0	24.0	10G8FFORX90L
-10	16	5/8	1" - 14 UNS	90.2	52.7	70.0	30.0	10G10FFORX90L
-12	20	3/4	1.3/16" - 12 UN	118.2	67.2	96.0	36.0	12G12FFORX90L
-16	25	1	1.7/16" - 12 UN	129.9	73.1	114.0	41.0	16G16FFORX90L
-20	32	1.1/4	1.11/16" - 12 UN	140.0	81.0	129.0	50.0	20G20FFORX90L



MegaCrimp®

SAE MFFOR

Male SAE flat face 'O' ring.

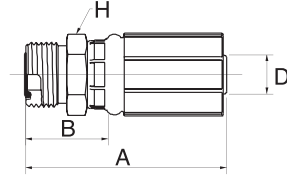

↔			🌀	↔			🌀
D				A	B	H	REF.
-size	DN	"		mm	mm	mm	G
-4	6	1/4	9/16" - 18 UNF	52.5	26.5	17.0	4G4MFFOR
-4	6	1/4	11/16" - 16 UN	54.0	28.0	19.0	4G6MFFOR
-5	8	5/16	11/16" - 16 UN	56.0	28.0	19.0	5G6MFFOR
-6	10	3/8	11/16" - 16 UN	56.0	28.1	19.0	6G6MFFOR
-6	10	3/8	13/16" - 16 UN	59.0	31.1	22.0	6G8MFFOR
-6	10	3/8	1" - 14 UNS	64.0	36.1	27.0	6G10MFFOR
-8	12	1/2	13/16" - 16 UN	68.2	30.7	22.0	8G8MFFOR
-8	12	1/2	1" - 14 UNS	73.0	35.5	27.0	8G10MFFOR
-10	16	5/8	1" - 14 UNS	73.0	35.5	27.0	10G10MFFOR
-10	16	5/8	1.3/16" - 12 UN	77.0	39.5	32.0	10G12MFFOR
-12	20	3/4	1.3/16" - 12 UN	90.0	39.0	32.0	12G12MFFOR
-12	20	3/4	1.7/16" - 12 UN	95.0	44.0	41.0	12G16MFFOR
-16	25	1	1.7/16" - 12 UN	102.0	45.2	41.0	16G16MFFOR
-16	25	1	1.11/16" - 12 UN	105.0	48.2	46.0	16G20MFFOR
-20	32	1.1/4	1.11/16" - 12 UN	109.0	50.0	46.0	20G20MFFOR

SAE 45° FSX

Female SAE swivel. 45° inverted cone.

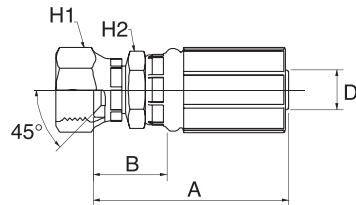

↔			🌀	↔				🌀
D				A	B	H1	H2	REF.
-size	DN	"		mm	mm	mm	mm	G
-4	6	1/4	7/16" - 20 UNF	48.0	22.0	14.3	12.7	4G4FSX
-4	6	1/4	1/2" - 20 UNF	46.5	20.5	17.5	12.7	4G5FSX
-4	6	1/4	5/8" - 18 UNF	48.5	22.5	19.1	15.9	4G6FSX
-5	8	5/16	5/8" - 18 UNF	52.0	24.0	19.1	15.9	5G6FSX
-6	10	3/8	5/8" - 18 UNF	52.0	24.1	19.1	15.9	6G6FSX
-6	10	3/8	3/4" - 16 UNF	51.5	23.5	22.2	17.5	6G8FSX
-8	12	1/2	3/4" - 16 UNF	60.0	22.5	22.2	20.6	8G8FSX
-8	12	1/2	7/8" - 14 UNF	63.0	25.5	27.0	20.6	8G10FSX
-12	20	3/4	1.1/16" - 14 UNS	78.5	27.5	31.8	27.0	12G12FSX



MegaCrimp®

SAE 24° MFA

Male SAE parallel. 24° inverted cone.

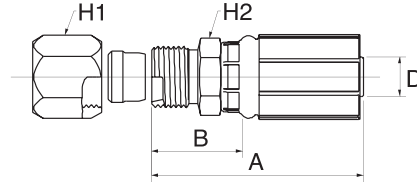

↔			🌀	↔				🌀
D				A	B	H1	H2	REF.
-size	DN	"		mm	mm	mm	mm	G
-4	6	1/4	7/16" - 20 UNF	53.0	27.0	14.3	12.7	4G4MFA
-4	6	1/4	1/2" - 20 UNF	50.0	24.0	15.9	12.7	4G5MFA
-6	10	3/8	7/16" - 20 UNF	55.0	27.1	14.3	15.9	6G4MFA
-6	10	3/8	1/2" - 20 UNF	55.0	27.1	15.9	15.9	6G5MFA
-6	10	3/8	9/16" - 18 UNF	56.0	28.1	17.5	15.9	6G6MFA
-6	10	3/8	3/4" - 16 UNF	61.0	33.1	22.2	19.1	6G8MFA
-8	12	1/2	3/4" - 16 UNF	70.5	33.0	22.2	20.6	8G8MFA
-8	12	1/2	7/8" - 14 UNF	72.0	34.5	25.4	22.2	8G10MFA
-12	20	3/4	1.1/16" - 12 UN	90.0	39.0	31.8	27.0	12G12MFA
-16	25	1	1.5/16" - 12 UN	100.0	43.2	38.1	34.9	16G16MFA

SAE FL

SAE 'O' ring flange. Code 61.

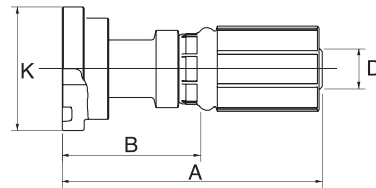

↔			🌀	↔				🌀
D				A	B	K	KIT	REF.
-size	DN	"		mm	mm	mm		G
-8	12	1/2	1/2"	80.0	42.5	30.2	8 PA-FL	8G8FL
-8	12	1/2	3/4"	80.0	42.5	38.1	12 PA-FL	8G12FL
-10	16	5/8	3/4"	98.0	60.5	38.1	12 PA-FL	10G12FL
-12	20	3/4	3/4"	98.0	47.0	38.1	12 PA-FL	12G12FL
-12	20	3/4	1"	88.8	37.8	44.5	16 PA-FL	12G16FL
-16	25	1	3/4"	128.0	71.2	38.1	12 PA-FL	16G12FL
-16	25	1	1"	105.0	48.2	44.5	16 PA-FL	16G16FL
-16	25	1	1.1/4"	105.0	48.2	50.8	20 PA-FL	16G20FL
-16	25	1	1.1/2"	96.0	39.2	60.3	24 PA-FL	16G24FL
-20	32	1.1/4	1.1/4"	112.5	53.5	50.8	20 PA-FL	20G20FL
-20	32	1.1/4	1.1/2"	117.5	58.5	60.3	24 PA-FL	20G24FL
-24	40	1.1/2	1.1/2"	152.9	79.3	60.3	24PA-FL	24GSP24FL
-24	40	1.1/2	2"	152.9	79.3	71.4	32PA-FL	24GSP32FL
-32	50	2	2"	159.3	67.3	71.4	32PA-FL	32GSP32FL

Details on flange kits see page 218.



MegaCrimp®

SAE FL22M

SAE 'O' ring flange. Code 61. 22° swept elbow.
Medium drop (-12 to -20 drop dimensions meet ISO 12151-3).

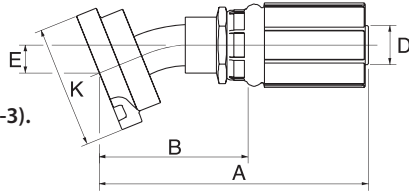

↔				↔			REF.		
D				A	B	E	K	KIT	REF.
-size	DN	"		mm	mm	mm	mm		G
-12	20	3/4	3/4"	121.0	70.0	11.0	38.1	12 PA-FL	12G12FL22M
-16	25	1	1"	142.5	85.7	14.0	44.5	16 PA-FL	16G16FL22M
-20	32	1.1/4	1.1/4"	152.5	93.5	15.0	50.8	20 PA-FL	20G20FL22M

Details on flange kits see page 218.

SAE FL30M

SAE 'O' ring flange. Code 61. 30° swept elbow.
Medium drop (-16 drop dimension meets ISO 12151-3).

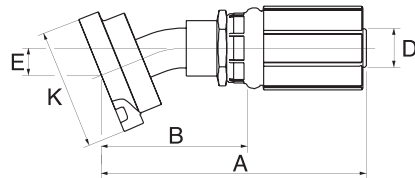

↔				↔			REF.		
D				A	B	E	K	KIT	REF.
-size	DN	"		mm	mm	mm	mm		G
-16	25	1	1"	144.5	87.7	19.0	44.5	16 PA-FL	16G16FL30M
-24	40	1.1/2	1.1/2"	209.0	135.2	25.0	60.4	24 PA-FL	24GSP24FL30S

S: Short drop. / Details on flange kits see page 218.



MegaCrimp®

SAE FL45

SAE 'O' ring flange. Code 61. 45° swept elbow.
Short and medium drop dimensions for size -8 to -20 meet ISO 12151-3.

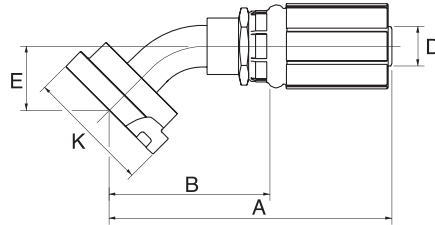

D				A	B	E	K	KIT	REF.
-size	DN	"		mm	mm	mm	mm		G
-8	12	1/2	1/2"	84.9	47.5	21.7	30.2	8 PA-FL	8G8FL45M
-8	12	1/2	3/4"	104.8	67.3	26.0	38.1	12 PA-FL	8G12FL45M
-12	20	3/4	3/4"	107.2	56.2	26.6	38.1	12 PA-FL	12G12FL45M
-12	20	3/4	1"	124.5	73.5	28.0	44.5	16 PA-FL	12G16FL45S
-16	25	1	3/4"	118.7	61.9	26.6	38.1	12 PA-FL	16G12FL45
-16	25	1	1"	142.5	85.7	28.0	44.5	16 PA-FL	16G16FL45S
-16	25	1	1.1/4"	149.0	92.2	32.0	50.8	20 PA-FL	16G20FL45S
-20	32	1.1/4	1.1/4"	157.0	98.0	32.0	50.8	20 PA-FL	20G20FL45S
-24	40	1.1/2	1.1/2"	202.0	128.6	38.0	60.4	24 PA-FL	24GSP24FL45S
-24	40	1.1/2	1.1/2"	200.0	126.3	52.0	71.4	32 PA-FL	24GSP32FL45S
-32	50	2	2"	261.0	168.6	56.0	71.4	32 PA-FL	32GSP32FL45-066

Details on flange kits see page 218.

SAE FL60

SAE 'O' ring flange. Code 61. 60° swept elbow.
Short and medium drop dimensions for size -12 to -24 meet ISO 12151-3.

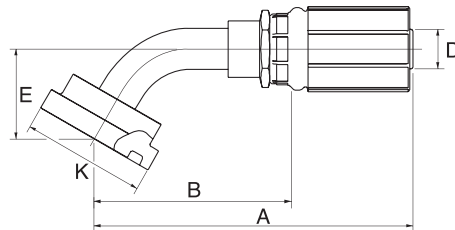

D				A	B	E	K	KIT	REF.
-size	DN	"		mm	mm	mm	mm		G
-12	20	3/4	3/4"	128.0	77.0	37.0	38.1	12 PA-FL	12G12FL60
-12	20	3/4	1"	132.0	81.0	44.0	44.5	16 PA-FL	12G16FL60M
-24	40	1.1/2	1.1/2"	231.0	157.5	53.0	60.4	24 PA-FL	24GSP24FL60S

Details on flange kits see page 218.



MegaCrimp®

SAE FL90

SAE 'O' ring flange. Code 61. 90° swept elbow.
Short and medium drop dimensions for size -8 to -24 meet ISO 12151-3.

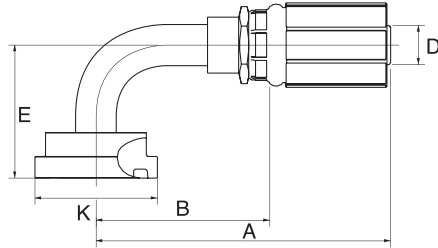

↔			↔				↔	
D			A	B	E	K	KIT	REF.
-size	DN	"	mm	mm	mm	mm		G
-8	12	1/2	91.2	53.7	40.0	30.2	8 PA-FL	8G8FL90M
-8	12	1/2	91.5	54.0	58.0	38.1	12 PA-FL	8G12FL90M
-10	16	5/8	100.0	62.5	58.0	38.1	12 PA-FL	10G12FL90M
-12	20	3/4	97.3	46.3	54.4	38.1	12 PA-FL	12G12FL90M
-12	20	3/4	119.8	68.8	61.0	44.5	16 PA-FL	12G16FL90S
-16	25	1	139.3	82.5	61.0	44.5	16 PA-FL	16G16FL90S
-16	25	1	139.3	82.5	68.0	50.8	20 PA-FL	16G20FL90S
-16	25	1	118.2	61.4	61.6	60.3	24 PA-FL	16G24FL90
-20	32	1.1/4	122.1	63.1	61.8	44.5	16 PA-FL	20G16FL90S
-20	32	1.1/4	158.1	99.1	68.0	50.8	20 PA-FL	20G20FL90S
-20	32	1.1/4	158.1	99.1	81.0	60.3	24 PA-FL	20G24FL90S
-24	40	1.1/2	184.0	109.9	81.0	60.4	24 PA-FL	24GSP24FL90S
-24	40	1.1/2	175.0	101.9	80.0	71.4	32 PA-FL	24GSP32FL90-080
-32	50	2	222.0	130.1	114.0	71.4	32 PA-FL	32GSP32FL90-114

Details on flange kits see page 218.



MegaCrimp®

FLK

Komatsu type 'O' ring flange.

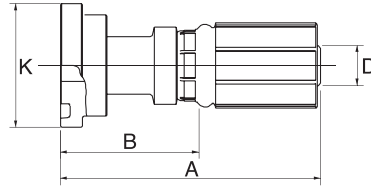

D				A B K			REF.
-size	DN	"		mm	mm	mm	G
-8	12	1/2	5/8"	80.0	42.5	34.2	8G10FLK
-10	16	5/8	5/8"	119.0	81.5	34.2	10G10FLK

FLK45

Komatsu type 'O' ring flange. 45° swept elbow.

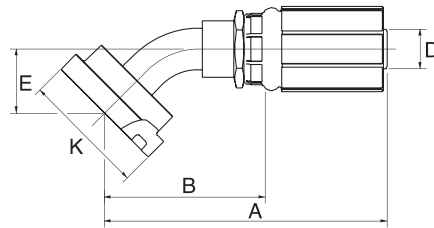

D				A B E K				REF.
-size	DN	"		mm	mm	mm	mm	G
-10	16	5/8	5/8"	106.5	69.0	26.0	34.2	10G10FLK45

FLK90

Komatsu type 'O' ring flange. 90° swept elbow.

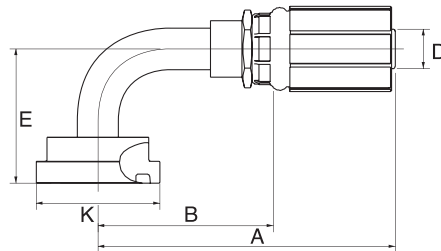

D				A B E K				REF.
-size	DN	"		mm	mm	mm	mm	G
-10	16	5/8	5/8"	99.0	61.5	55.0	34.2	10G10FLK90



MegaCrimp®

DIN 24° FDLORX

Female DIN 'O' ring swivel. 24° cone. Light series.

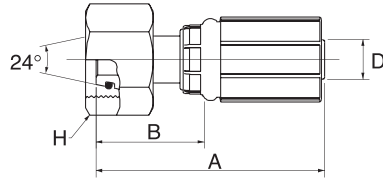

D				A	B	H	REF.
-size	DN	"		mm	mm	mm	G
-4	6	1/4	M12 x 1.5	51.8	28.8	14.0	4G6FDLORX
-4	6	1/4	M14 x 1.5	55.7	29.7	17.0	4G8FDLORX
-4	6	1/4	M16 x 1.5	55.3	29.3	19.0	4G10FDLORX
-4	6	1/4	M18 x 1.5	55.7	29.7	22.0	4G12FDLORX
-5	8	5/16	M14 x 1.5	52.0	28.4	17.0	5G8FDLORX
-5	8	5/16	M16 x 1.5	53.9	29.7	19.0	5G10FDLORX
-5	8	5/16	M18 x 1.5	58.5	30.0	22.0	5G12FDLORX
-6	10	3/8	M16 x 1.5	57.1	29.2	19.0	6G10FDLORX
-6	10	3/8	M18 x 1.5	57.8	29.9	22.0	6G12FDLORX
-6	10	3/8	M20 x 1.5	60.4	32.5	24.0	6G14FDLORX
-6	10	3/8	M22 x 1.5	56.7	28.8	27.0	6G15FDLORX
-8	12	1/2	M18 x 1.5	70.2	32.7	22.0	8G12FDLORX
-8	12	1/2	M22 x 1.5	67.0	29.5	27.0	8G15FDLORX
-8	12	1/2	M26 x 1.5	67.9	30.4	32.0	8G18FDLORX
-10	16	5/8	M26 x 1.5	67.8	30.3	32.0	10G18FDLORX
-12	20	3/4	M26 x 1.5	83.8	32.8	32.0	12G18FDLORX
-12	20	3/4	M30 x 2.0	85.8	34.8	36.0	12G22FDLORX
-16	25	1	M36 x 2.0	81.6	36.7	41.0	16G28FDLORX
-20	32	1.1/4	M45 x 2.0	90.4	44.1	50.0	20G35FDLORX
-24	40	1.1/2	M52 x 2.0	135.7	62.0	60.0	24G5P42FDLORX



MegaCrimp®

DIN 24° FDLORX45

Female DIN 'O' ring swivel. 24° cone. Light series.
45° swept elbow. Drop dimensions meet ISO 12151-2.

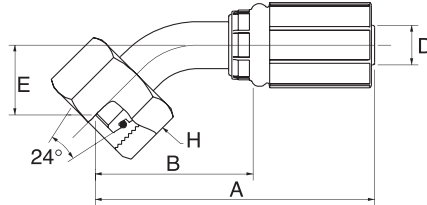

D				A	B	E	H	REF.
-size	DN	"		mm	mm	mm	mm	G
-4	6	1/4	M12 x 1.5	65.5	39.5	16.9	14.0	4G6FDLORX45
-4	6	1/4	M14 x 1.5	62.6	36.5	16.2	19.0	4G8FDLORX45
-4	6	1/4	M16 x 1.5	64.4	38.3	17.9	19.0	4G10FDLORX45
-4	6	1/4	M18 x 1.5	66.7	40.7	18.3	22.0	4G12FDLORX45
-5	8	5/16	M14 x 1.5	67.1	39.1	16.9	17.0	5G8FDLORX45
-5	8	5/16	M16 x 1.5	63.4	39.3	17.1	19.0	5G10FDLORX45
-5	8	5/16	M18 x 1.5	67.7	39.7	18.9	22.0	5G12FDLORX45
-6	10	3/8	M16 x 1.5	68.5	40.5	18.6	19.0	6G10FDLORX45
-6	10	3/8	M18 x 1.5	68.8	40.9	18.9	22.0	6G12FDLORX45
-6	10	3/8	M22 x 1.5	72.3	44.4	22.5	27.0	6G15FDLORX45
-8	12	1/2	M18 x 1.5	92.9	55.4	29.7	22.0	8G12FDLORX45
-8	12	1/2	M22 x 1.5	84.6	47.1	20.2	27.0	8G15FDLORX45
-8	12	1/2	M26 x 1.5	94.9	57.2	26.9	32.0	8G18FDLORX45
-10	16	5/8	M26 x 1.5	93.5	56.0	24.8	32.0	10G18FDLORX45
-12	20	3/4	M30 x 2.0	104.6	66.1	29.8	36.0	12G22FDLORX45
-16	25	1	M36 x 2.0	135.4	78.8	30.9	41.0	16G28FDLORX45
-20	32	1.1/4	M45 x 2.0	152.4	93.4	37.5	50.0	20G35FDLORX45
-24	40	1.1/2	M52 x 2.0	208.9	135.2	44.0	60.0	24GSP42FDLORX45



MegaCrimp®

DIN 24° FDLORX90

Female DIN 'O' ring swivel. 24° cone. Light series.
90° swept elbow. Drop dimensions meet ISO 12151-2.

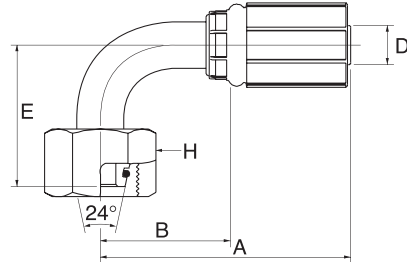

D				A	B	E	H	REF.
-size	DN	"		mm	mm	mm	mm	G
-4	6	1/4	M12 x 1.5	57.6	31.5	35.0	14.0	4G6FDLORX90
-4	6	1/4	M14 x 1.5	57.5	31.5	35.0	17.0	4G8FDLORX90
-4	6	1/4	M16 x 1.5	57.6	31.5	36.5	19.0	4G10FDLORX90
-4	6	1/4	M18 x 1.5	59.6	33.5	37.0	22.0	4G12FDLORX90
-5	8	5/16	M14 x 1.5	61.4	33.4	35.0	17.0	5G8FDLORX90
-5	8	5/16	M16 x 1.5	62.5	34.4	36.5	19.0	5G10FDLORX90
-5	8	5/16	M15 x 1.5	59.0	31.0	37.0	22.0	5G12FDLORX90
-6	10	3/8	M16 x 1.5	60.1	32.2	36.5	19.0	6G10FDLORX90
-6	10	3/8	M18 x 1.5	60.1	32.2	37.0	22.0	6G12FDLORX90
-6	10	3/8	M22 x 1.5	60.1	32.2	42.0	27.0	6G15FDLORX90
-8	12	1/2	M18 x 1.5	74.3	36.9	53.1	22.0	8G12FDLORX90
-8	12	1/2	M22 x 1.5	77.9	40.4	42.0	27.0	8G15FDLORX90
-8	12	1/2	M26 x 1.5	81.5	44.0	51.5	32.0	8G18FDLORX90
-10	16	5/8	M26 x 1.5	85.1	47.6	51.5	32.0	10G18FDLORX90
-12	20	3/4	M26 x 1.5	100.3	49.3	51.5	32.0	12G18FDLORX90
-12	20	3/4	M30 x 2.0	107.3	56.3	62.0	36.0	12G22FDLORX90
-16	25	1	M36 x 2.0	131.1	74.3	70.0	41.0	16G28FDLORX90
-20	32	1.1/4	M45 x 2.0	141.8	82.8	80.0	50.0	20G35FDLORX90
-24	40	1.1/2	M52 x 2.0	194.6	121.0	92.0	60.0	24GSP42FDLORX90



MegaCrimp®

DIN 24° MDL

Male DIN parallel. 24° inverted cone. Light series.

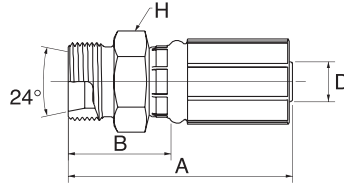

D				A	B	H	REF.
-size	DN	"		mm	mm	mm	G
-4	6	1/4	M12 x 1.5	45.8	19.8	14.0	4G6MDL
-4	6	1/4	M14 x 1.5	46.8	20.8	17.0	4G8MDL
-4	6	1/4	M16 x 1.5	47.8	21.8	17.0	4G10MDL
-4	6	1/4	M18 x 1.5	50.0	24.0	19.0	4G12MDL
-5	8	5/16	M14 x 1.5	48.8	20.8	17.0	5G8MDL
-5	8	5/16	M16 x 1.5	49.8	21.8	17.0	5G10MDL
-5	8	5/16	M18 x 1.5	50.8	22.8	19.0	5G12MDL
-6	10	3/8	M16 x 1.5	49.8	21.9	17.0	6G10MDL
-6	10	3/8	M18 x 1.5	50.8	22.9	19.0	6G12MDL
-6	10	3/8	M22 x 1.5	51.8	23.9	24.0	6G15MDL
-8	12	1/2	M18 x 1.5	60.6	23.1	22.0	8G12MDL
-8	12	1/2	M22 x 1.5	61.5	24.0	24.0	8G15MDL
-8	12	1/2	M26 x 1.5	63.0	25.5	27.0	8G18MDL
-10	16	5/8	M26 x 1.5	62.5	25.0	27.0	10G18MDL
-12	20	3/4	M26 x 1.5	75.9	24.9	27.0	12G18MDL
-12	20	3/4	M30 x 2.0	78.0	27.0	32.0	12G22MDL
-16	25	1	M36 x 2.0	87.2	30.4	41.0	16G28MDL
-20	32	1.1/4	M45 x 2.0	94.1	35.1	46.0	20G35MDL
-24	40	1.1/2	M52 x 2.0	120.0	46.4	55.0	24GSP42MDL



MegaCrimp®

DIN 24° FDHORX

Female DIN 'O' ring swivel. 24° cone. Heavy series.

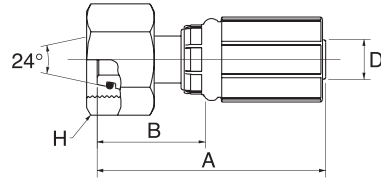

D				A	B	H	REF.
-size	DN	"		mm	mm	mm	G
-4	6	1/4	M14 x 1.5	51.8	25.8	17.0	4G6FDHORX
-4	6	1/4	M16 x 1.5	54.4	28.4	19.0	4G8FDHORX
-4	6	1/4	M18 x 1.5	55.3	29.3	22.0	4G10FDHORX
-4	6	1/4	M20 x 1.5	55.7	29.7	24.0	4G12FDHORX
-5	8	5/16	M18 x 1.5	58.0	29.9	22.0	5G10FDHORX
-5	8	5/16	M20 x 1.5	58.0	30.0	24.0	5G12FDHORX
-5	8	5/16	M22 x 1.5	58.0	30.0	27.0	5G14FDHORX
-6	10	3/8	M18 x 1.5	57.1	29.2	22.0	6G10FDHORX
-6	10	3/8	M20 x 1.5	57.8	29.9	24.0	6G12FDHORX
-6	10	3/8	M22 x 1.5	60.4	32.5	27.0	6G14FDHORX
-8	12	1/2	M20 x 1.5	70.2	32.7	24.0	8G12FDHORX
-8	12	1/2	M22 x 1.5	70.0	32.5	27.0	8G14FDHORX
-8	12	1/2	M24 x 1.5	71.1	33.6	30.0	8G16FDHORX
-8	12	1/2	M30 x 2.0	75.5	38.0	36.0	8G20FDHORX
-10	16	5/8	M24 x 1.5	71.9	34.4	30.0	10G16FDHORX
-10	16	5/8	M30 x 2.0	75.7	38.2	36.0	10G20FDHORX
-12	20	3/4	M30 x 2.0	91.7	40.7	36.0	12G20FDHORX
-12	20	3/4	M36 x 2.0	96.1	45.1	46.0	12G25FDHORX
-16	25	1	M36 x 2.0	102.5	45.7	46.0	16G25FDHORX
-16	25	1	M42 x 2.0	106.0	49.2	50.0	16G30FDHORX
-20	32	1.1/4	M52 x 2.0	116.8	57.8	60.0	20G38FDHORX
-24	40	1.1/2	M52 x 2.0	150.0	76.3	60.0	24GSP38FDHORX



MegaCrimp®

DIN 24° FDHORX45

Female DIN 'O' ring swivel. 24° cone. Heavy series.
45° swept elbow. Drop dimensions meet ISO 12151-2.

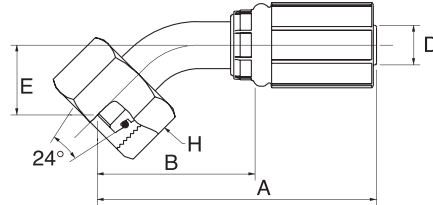

D				A	B	E	H	REF.
-size	DN	"		mm	mm	mm	mm	G
-4	6	1/4	M16 x 1.5	62.6	36.5	16.2	19.0	4G8FDHORX45
-4	6	1/4	M18 x 1.5	64.4	38.3	17.9	22.0	4G10FDHORX45
-4	6	1/4	M20 x 1.5	66.7	40.7	18.3	24.0	4G12FDHORX45
-5	8	5/16	M18 x 1.5	67.3	39.3	17.1	22.0	5G10FDHORX45
-5	8	5/16	M20 x 1.5	67.7	39.7	18.9	24.0	5G12FDHORX45
-6	10	3/8	M18 x 1.5	68.5	40.5	18.6	22.0	6G10FDHORX45
-6	10	3/8	M20 x 1.5	68.8	40.9	18.9	24.0	6G12FDHORX45
-6	10	3/8	M22 x 1.5	70.9	43.0	21.0	27.0	6G14FDHORX45
-8	12	1/2	M22 x 1.5	91.5	54.0	27.1	27.0	8G14FDHORX45
-8	12	1/2	M24 x 1.5	86.0	48.5	21.6	30.0	8G16FDHORX45
-10	16	5/8	M30 x 2.0	93.1	55.7	24.9	36.0	10G20FDHORX45
-12	20	3/4	M30 x 2.0	109.4	58.4	24.9	36.0	12G20FDHORX45
-12	20	3/4	M36 x 2.0	118.6	67.6	31.2	46.0	12G25FDHORX45
-16	25	1	M36 x 2.0	146.5	89.7	35.1	46.0	16G25FDHORX45
-16	25	1	M42 x 2.0	139.8	83.0	35.1	50.0	16G30FDHORX45
-20	32	1.1/4	M52 x 2.0	166.9	107.9	42.5	60.0	20G38FDHORX45
-24	40	1.1/2	M52 x 2.0	208.9	135.2	44.0	60.0	24GSP38FDHORX45



MegaCrimp®

DIN 24° FDHORX90

Female DIN 'O' ring swivel. 24° cone. Heavy series.
90° swept elbow. Drop dimensions meet ISO 12151-2.

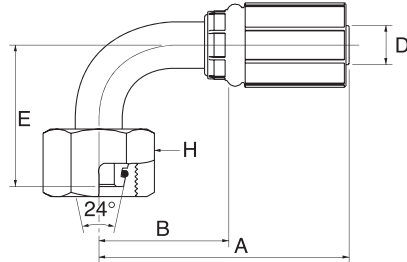

D				A	B	E	H	REF.
-size	DN	"		mm	mm	mm	mm	G
-4	6	1/4	M14 x 1.5	57.6	31.5	35.0	17.0	4G6FDHORX90
-4	6	1/4	M16 x 1.5	57.5	31.5	35.0	19.0	4G8FDHORX90
-4	6	1/4	M18 x 1.5	57.6	31.5	36.5	22.0	4G10FDHORX90
-4	6	1/4	M20 x 1.5	59.6	33.5	37.0	24.0	4G12FDHORX90
-5	8	5/16	M18 x 1.5	62.5	34.4	36.5	22.0	5G10FDHORX90
-5	8	5/16	M20 x 1.5	59.0	31.0	37.0	24.0	5G12FDHORX90
-5	8	5/16	M22 x 1.5	59.0	31.0	40.0	27.0	5G14FDHORX90
-6	10	3/8	M18 x 1.5	60.1	32.2	36.5	22.0	6G10FDHORX90
-6	10	3/8	M20 x 1.5	60.1	32.2	37.0	24.0	6G12FDHORX90
-6	10	3/8	M22 x 1.5	60.1	32.2	40.0	27.0	6G14FDHORX90
-8	12	1/2	M24 x 1.5	77.9	40.4	44.0	30.0	8G16FDHORX90
-10	16	5/8	M30 x 2.0	84.1	46.6	51.0	36.0	10G20FDHORX90
-10	16	5/8	M36 x 2.0	84.1	46.6	64.0	46.0	10G25FDHORX90
-12	20	3/4	M30 X 2.0	100.3	49.3	51.0	36.0	12G20FDHORX90
-12	20	3/4	M36 x 2.0	107.3	56.3	64.0	46.0	12G25FDHORX90
-16	25	1	M36 x 2.0	137.8	81.0	76.0	46.0	16G25FDHORX90
-16	25	1	M42 x 2.0	131.1	74.3	76.0	50.0	16G30FDHORX90
-20	32	1.1/4	M52 x 2.0	151.4	92.4	87.0	60.0	20G38FDHORX90
-24	40	1.1/2	M52 x 2.0	194.6	121.0	92.0	60.0	24G52FDHORX90



MegaCrimp®

DIN 24° MDH

Male DIN parallel. 24° inverted cone. Heavy series.

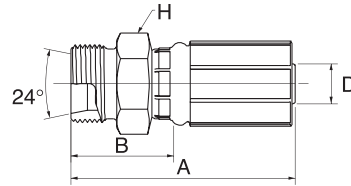

D				A	B	H	REF.
-size	DN	"		mm	mm	mm	G
-4	6	1/4	M16 x 1.5	53.0	27.0	17.0	4G8MDH
-4	6	1/4	M18 x 1.5	52.5	26.5	19.0	4G10MDH
-5	8	5/16	M18 x 1.5	53.8	25.8	19.0	5G10MDH
-5	8	5/16	M20 x 1.5	55.8	27.8	22.0	5G12MDH
-6	10	3/8	M18 x 1.5	55.0	27.1	19.0	6G10MDH
-6	10	3/8	M20 x 1.5	57.5	29.6	24.0	6G12MDH
-6	10	3/8	M22 x 1.5	59.5	31.6	24.0	6G14MDH
-8	12	1/2	M20 x 1.5	66.5	29.0	24.0	8G12MDH
-8	12	1/2	M24 x 1.5	69.0	31.5	27.0	8G16MDH
-10	16	5/8	M30 x 2.0	73.5	36.0	32.0	10G20MDH
-12	20	3/4	M30 x 2.0	84.9	33.9	32.0	12G20MDH
-12	20	3/4	M36 x 2.0	92.0	41.0	41.0	12G25MDH
-16	25	1	M36 x 2.0	97.2	40.4	41.0	16G25MDH
-16	25	1	M42 x 2.0	99.2	42.4	46.0	16G30MDH
-20	32	1.1/4	M52 X 2.0	108.1	49.1	55.0	20G38MDH

METRIC MSP

Metric standpipe.

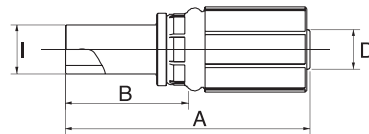

D			I	A	B	REF.
-size	DN	"	mm	mm	mm	GS
-4	6	1/4	L6	62.5	36.5	4G6MSP
-4	6	1/4	L8	62.5	36.5	4G8MSP
-4	6	1/4	L10	64.5	38.5	4G10MSP
-5	8	5/16	L8	64.5	36.5	5G8MSP
-5	8	5/16	L10	66.5	38.5	5G10MSP
-5	8	5/16	L12	66.5	38.5	5G12MSP
-6	10	3/8	L10	66.5	38.6	6G10MSP
-6	10	3/8	L12	66.5	38.6	6G12MSP
-8	12	1/2	L15	76.3	38.8	8G15MSP
-10	16	5/8	L18	77.2	39.7	10G18MSP
-12	20	3/4	L22	93.2	42.2	12G22MSP



MegaCrimp®

POWERWASH FPWX

Female PowerWash swivel.

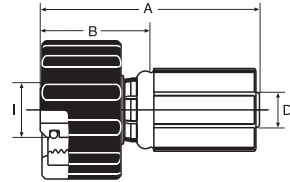

D				A	B	I	REF.
-size	DN	"		mm	mm	mm	G
-4	6	1/4	M22 x 1.5	54.0	28.0	13.9	4G15FPWX
-5	8	5/16	M22 x 1.5	55.5	27.5	13.9	5G15FPWX
-6	10	3/8	M22 x 1.5	55.5	27.6	13.9	6G15FPWX

POWERWASH PWSP

Male PowerWash standpipe with 'O' ring.

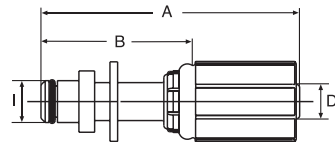

D			A	B	I	REF.
-size	DN	"	mm	mm	mm	G
-4	6	1/4	59.6	36.5	9.9	4G10PWSP
-5	8	5/16	64.5	36.5	9.9	5G10PWSP
-5	8	5/16	67.5	39.5	10.9	5G11PWSP
-6	10	3/8	64.5	36.6	9.9	6G10PWSP
-6	10	3/8	67.5	39.6	10.9	6G11PWSP



Flange kits

SAE PA-FL FLANGE KIT

SAE flange kit. Code 61. SAE standard pressure.

Each kit comprises:

- 2 flange halves (PA-FL75)
- 4 bolts
- 4 washers
- 'O' ring (PA-FL77)

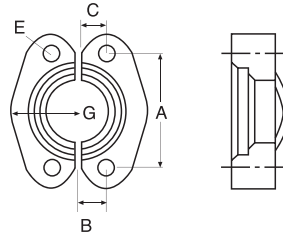

↔			⌚	↔					🔧
D				A	B	C	E	G	REF.
-size	DN	"	MPa	mm	mm	mm	mm	mm	PA-FL
-8	12	1/2	35.0	38.1	8.7	7.7	8.5	21.8	8PA-FL
-12	19	3/4	35.0	47.6	11.1	10.1	10.5	24.9	12PA-FL
-16	25	1	35.0	52.3	13.1	12.1	10.5	28.1	16PA-FL
-20	32	1.1/4	28.0	58.7	15.1	14.1	11.9	35.3	20PA-FL
-24	40	1.1/2	21.0	69.8	17.8	16.9	13.5	40.1	24PA-FL
-32	51	2	21.0	77.7	20.4	20.4	13.5	47.2	32PA-FL

Code 61: -8, -12, -16: 35.0 MPa (5000 psi); -20: 28.0 MPa (4000 psi); -24 & -32: 21.0 MPa (3000 psi).

SAE PH-FLH FLANGE KIT

SAE flange kit. Code 62. SAE high pressure.

Each kit comprises:

- 2 flange halves (PH-FLH75)
- 4 bolts
- 4 washers
- 'O' ring (PH-FLH77)

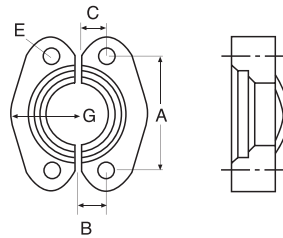

↔			⌚	↔					🔧
D				A	B	C	E	G	REF.
-size	DN	"	MPa	mm	mm	mm	mm	mm	PH-FLH
-8	12	1/2	41.5	40.5	9.1	8.1	8.5	22.6	8PH-FLH
-12	19	3/4	41.5	50.8	11.9	10.9	10.5	28.9	12PH-FLH
-16	25	1	41.5	57.1	13.9	12.9	12.0	33.8	16PH-FLH
-20	32	1.1/4	41.5	66.7	15.9	14.9	13.5	37.6	20PH-FLH
-24	40	1.1/2	41.5	79.4	18.2	17.3	16.5	46.5	24PH-FLH
-32	51	2	41.5	96.8	22.2	21.1	20.0	55.9	32PH-FLH



Flange kits

SAE PH-FLH DUAL FLANGE KIT

SAE flange kit. Code 62 (metric). SAE high pressure.

Each kit comprises:

- dual flange
- 4 bolts
- 4 washers
- 'O' ring

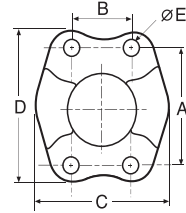

D				A	B	C	D	E	REF.
-size	DN	"	MPa	mm	mm	mm	mm	mm	PH-FLH
-8	13	1/2	40.0	40.5	18.2	48.0	57.0	8.8	8FLHCFM
-12	19	3/4	40.0	50.8	23.8	60.0	72.0	10.5	12FLHCFM
-16	25	1	40.0	57.2	27.8	70.0	81.0	13.0	16FLHCFM
-20	32	1.1/4	40.0	66.7	31.8	78.0	95.0	15.0	20FLHCFM
-24	38	1.1/2	40.0	79.4	36.6	96.0	113.0	17.0	24FLHCFM
-32	51	2	40.0	96.8	44.4	114.0	134.0	22.1	32FLHCFM



SELF-ASSEMBLY MACHINERY

Workshop

In the Gates workshop, safe, fast and efficient assembly of hydraulic hoses and couplings is made simple. All machines are custom-designed to work with a well-defined range of Gates hoses and couplings allowing production of factory-quality assemblies fully complying with European Directives and the most stringent international standards.

No matter what your workshop needs, whether you are a starter, a professional, or a full-service workshop, Gates has the right product offering for you.



	Cutting	Marking	Crimping
<i>Full service 2"</i>	MXK 50 	MSX 50 	MCX 50 
	MXK 30 	MSX 50 	MCX 30 
<i>Professional service up to 1.1/4"</i>	MXK 25 	MSX 50 	MCX 25 







Mobile service

A Gates hose assembly is much more than the sum of its components. It is the combined result of a rigorous test regime and of a tightly controlled manufacturing process, both at Gates and at the point of assembly.

To reduce the risk of premature failure due to variations in the assembly process, Gates has developed a special proposition for mobile service operations allowing them to benefit from the simplified and superior Global range of no-skive hoses and couplings.

Thanks to the Gates Integrated System, mobile service operators can offer their customers the superior quality and performance which make the world's most trusted hose assemblies.



	Cutting	Marking	Crimping
	MKX 25	MSX 50	MCX 30
Professional service up to 1.1/4"			
	MKX 25	MSX 50	MCX 25
Starter up to 1"			



SELF-ASSEMBLY MACHINERY

Field service

In the field, every minute counts. In today's environment, equipment, whether it be agricultural, construction or mining, simply cannot afford unnecessary downtime. That's why Gates has developed a range of small, portable and easy-to-use crimpers specifically designed for end-users on site.

Since these simple, lightweight machines are designed as part of the Gates Integrated System, end-users are assured of factory-quality no-skive assemblies – even in the field!



	MCX 20	
No-skive spiral hose up to 1"		
	MC 1001 manual	MC 1001 air operated
Wire-braid hose up to 1"		



Crimping machines: overview

MC 1001

Lightweight, portable crimper designed for reliability in field service. Comes with separate box, designed to contain complete set of dies. The pneumatic version has a foot-operated air pump. Crimps no-skive MegaCrimp® couplings for wire-braid hose up to 1".



Ref: 7480-19164: manual machine



Ref: 7480-19165: air operated machine

MCX 20

Powerful, lightweight, portable hand-operated crimper, ideal for field service operations. Comes with separate box, designed to contain complete set of dies. Crimps no-skive GlobalSpiral™ couplings up to 1" and no-skive MegaCrimp® couplings for wire-braid hose up to 1.1/4".



Ref: 7480-19181



SELF-ASSEMBLY MACHINERY

Crimping machines: overview

MCX 25

Compact crimper for low-volume production. Ideal as starter machine or for small workshops. Crimps no-skive GlobalSpiral™ couplings up to 1" and no-skive MegaCrimp® couplings for wire-braid hose up to 1.1/4". Equipped with a die set storage rack allowing for logically organised die storage within easy reach of the operator, thus speeding up die selection and assembly. Also available for mobile service with DC power pack.



MCX 30

Compact, operator-friendly machine to crimp the complete Gates range up to 1.1/4". Equipped with a die set storage rack allowing for logically organised die storage within easy reach of the operator, thus speeding up die selection and assembly. Also available for mobile service with DC power pack.



MCX 50

Full-range crimper (up to 2" six spiral wire hose) for the professional workshop. Optional foot pedal to enable hands-free operation. Equipped with a die set storage rack allowing for logically organised die storage within easy reach of the operator, thus speeding up die selection and assembly.



Ref: 7480-19188: 3 phase



Crimping machines: accessories

Quick die change

The universal quick die change allows fast and easy change of dies without risk of damage to the die sets. The transparent shield of the quick die change allows you to quickly and safely position die sets into the master dies of the crimper head. A single press of the closing button is enough to lock the dies safely in place and rapidly produce a perfect hose assembly. When buying an electrical crimping machine, the QDC that goes together with the respective machine will be included in the package.

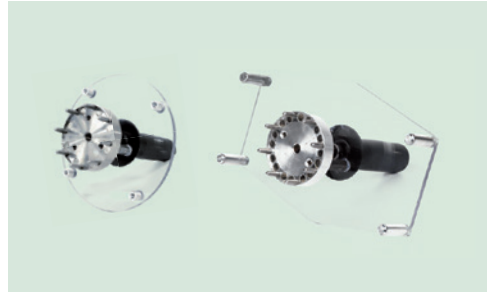

Ref: 7480-19194: QDC MCX 25
7480-19200: QDC MCX 30

Marking dies

To facilitate compliance with the European Machinery Directive, which insists that finished assemblies are marked with the manufacturer's name and the manufacturing date code, a range of marking dies is now available for the MCX 50, MCX 30, MCX 25 and MCX 20 machines.



Please contact Gates for order information.

MCX-matic electronic control

For workshop professionals who want to automate their assembly production and limit the chance for micrometer setting mistakes, MCX-matic electronic control is available. This built-in feature with pressure force display eliminates manual gauge setting and controls the maximum pressure needed for your requested crimp diameter.



Ref: 7480-19196

e-Crimp: online crimp settings in seconds

You no longer need to search through a stockpile of cd-roms to find the correct crimp settings. Go to www.gates.com/europe/e-crimp and use our fast sign-up procedure to obtain correct crimp settings in seconds! After logging in, you can access the Crimp Data Sheets, sorted by machine type. Select your machine type and print out an up-to-date sheet with accurate crimp data information or download the pdf documents to your desktop or mobile devices. Regular e-mails from our engineers keep you up to date about the newest crimp settings in the market.





SELF-ASSEMBLY MACHINERY

Crimping machines: technical specifications

Crimpers		MC 1001		MCX 20	
		manual	pneumatic	manual	
power supply		--	7bar/100psi	--	
maximum capacity	WB	1"	1"	1.1/4"	
	4SW	--	--	1"	
	6SW	--	--	--	
crimping force (ton)		27	27	90	
motor (kW)		--	--	--	
die set		MC1000-Dxx	MC1000-Dxx	263-Dxx	
cycle time (sec)		--	--	--	
die storage		box	box	box	
dimensions (mm)	H	460	460	370	
	W	280	280	450	
	L	390	390	470	
weight (kg)		24	22	35	
product number		7480-19164	7480-19165	7480-19181	
options	marking dies	--	--	x***	
	quick die change	--	--	--	
	MCX-matic control	--	--	--	
	back stop	--	--	--	
	foot pedal	--	standard	--	



	MCX 25			MCX 30			MCX 50
	DC	1 phase	3 phase	DC	1 phase	3 phase	3 phase
	12V	220V	380V	12V	220V	380V	380V
	1.1/4"	1.1/4"	1.1/4"	1.1/4"	1.1/4"	1.1/4"	2"
	1"	1"	1"	1.1/4"	1.1/4"	1.1/4"	2"
	--	--	--	1.1/4"	1.1/4"	1.1/4"	2"
	130	130	130	180	180	180	280
	1.8	2.2	3	1.8	2.2	3	5.5
	239-Dxx	239-Dxx	239-Dxx	239-Dxx	239-Dxx	239-Dxx	239*/237-Dxx
	39	39	19	41	41	20	18
	rack	rack	rack	rack	rack	rack	rack
	550	790	790	550	790	790	1400
	475	600	600	475	600	600	580
	395	550	550	395	550	550	610
	115	160	160	125	170	170	410
	7480-19182	7480-19183	7480-19184	7480-19185	7480-19186	7480-19187	7480-19188
	x**	x**	x**	x**	x**	x**	x**
	x	x	x	x	x	x	x
	--	--	--	--	--	--	x
	--	--	--	--	--	--	7480-19198
	--	--	--	--	--	--	7480-19199

* only with intermediate dies
 ** marking die in type 239 only up to 239-D37
 *** marking die in type 263 only up to 263-D35



SELF-ASSEMBLY MACHINERY

Cutting machines: overview

MKX 25

Compact cutting machine, perfectly suitable for the small workshop. Cuts up to 1.1/4" four spiral wire hose.



Ref: 7480-19190: 1 phase / 7480-19189: 12V

MKX 30

Robust cutter for all types of workshops. Cuts up to 1.1/4" six spiral wire hose.



Ref: 7480-19191: 3 phase

MKX 50

A heavy-duty pneumatic hose cutter allowing quick and reliable production across all hose size ranges. Cuts up to 2" six spiral wire hose. For workshop professionals who want to further enhance their set-up and improve the ease-of-use, we have a complete kit available including also a machine table and air compressor.





SELF-ASSEMBLY MACHINERY

Tools

Marking machine

This hand-operated marking machine is a precise, compact service-free bench unit for Gates ferrules, one-piece and two-piece fittings. The MSX 50 is equipped with a hand wheel to adjust the character setting to the ferrule for the requested marking depth. The slot in the character holder allows for easy character placement. Please contact Gates for order info on the required characters.



Ref: 7480-19193

MegaCrimp® vernier caliper

A handy tool which measures finished outside diameters. Special design for easy measuring of the finished diameters on -4, -5 and -6 MegaCrimp®. Comes in a solid case.



Ref: 7369-0322

MegaCrimp® insertion tool

The MegaCrimp® coupling insertion tool offers an easy way to confirm the right insertion depth for all Gates wire-braid hydraulic hoses. It also verifies the squareness of cut!



Ref: 7482-1342

Rotational table

Rotational table ideal for the unwinding of hose coils.



Ref: 7480-19135



Die selection matrix

-size	Hose					Coupling	Die	MC 1001	MCX 20	MCX 25	MCX 30	MCX 50
								MC1000-Dxx	263-Dxx	239-Dxx	239-Dxx	239*/237-Dxx
-4	M6K	M5K	M4K	M3K		G	D21	x	x	x	x	x
	CM2T	G2	G1	G1H	GTH	G	D21	x	x	x	x	x
			TH8	TH7	ACR	G	D21	x	x	x	x	x
-5	2JC	1JC	GP80+	GP60	GP40	G	D21	x	x	x	x	x
		M5K	M4K	M3K		G	D22	x	x	x	x	x
	CM2T	G2	G1		GTH	G	D22	x	x	x	x	x
-6				TH7		G	D22	x	x	x	x	x
	2JC	1JC	GP80+	GP60	GP40	G	D22	x	x	x	x	x
		M5K	M4K	M3K		G	D22	x	x	x	x	x
-8	CM2T	G2	G1	G1H	GTH	G	D22	x	x	x	x	x
			TH8	TH7	ACR	G	D22	x	x	x	x	x
	2JC	1JC	GP80+	GP60	GP40	G	D22	x	x	x	x	x
	EFG6K	EFG5K	EFG4K			GS	D33		x	x	x	x
-10		M5K	M4K	M3K		G	D33	x	x	x	x	x
	CM2T	G2	G1	G1H	GTH	G	D33	x	x	x	x	x
			TH8	TH7	ACR	G	D33	x	x	x	x	x
-12	2JC	1JC	GP80+	GP60	GP40	G	D33	x	x	x	x	x
		EFG6K	EFG5K	EFG4K			GS	D33		x	x	x
			M4K	M3K		G	D34	x	x	x	x	x
-16	CM2T	G2	G1	G1H	GTH	G	D34	x	x	x	x	x
					ACR	G	D34	x	x	x	x	x
			GP80+	GP60	GP40	G	D34	x	x	x	x	x
	EFG6K	EFG5K	EFG4K			GS	D35		x	x	x	x
-20				M3K		G	D35	x	x	x	x	x
	CM2T	G2	G1	G1H	GTH	G	D35	x	x	x	x	x
		GMV	TH8	TH7	ACR	G	D35	x	x	x	x	x
-24			GP80+	GP60	GP40	G	D35	x	x	x	x	x
		EFG6K	EFG5K	EFG4K			GS	D35		x	x	x
				M3K		G	D37	x	x	x	x	x
-32	CM2T	G2	G1	G1H	GTH	G	D37	x	x	x	x	x
		GMV	TH8	TH7	ACR	G	D37	x	x	x	x	x
			GP80+	GP60	GP40	G	D37	x	x	x	x	x
	EFG6K	EFG5K	EFG4K			GS	D37		x	x	x	
-40						G	D39		x	x	x	x
		G2	G1	G1H		G	D39		x	x	x	x
		GMV			ACR	G	D39		x	x	x	x
-48			GP80+	GP40		G	D39		x	x	x	x
			EFG4K	EFG3K		GS	D39				x	x
		EFG6K	EFG5K			GS	D310				x	x
-60						GSP	D310					x
		G2	G1	G1H		GSP	D310					x
		GMV			ACR	GSP	D310					x
-72			GP80+	GP40		GSP	D310					x
				EFG3K		GSP	D311					x
		EFG6K	EFG5K			GSH	D311					x
-96						GSP	D312					x
		G2	G1	G1H		GSP	D312					x
		GMV			ACR	GSP	D312					x
-120			GP80+			GSP	D312					x
				EFG3K		GSP	D313					x
			EFG5K			GSH	D314					x

wire braid reinforcement

4 spiral wire reinforcement

6 spiral wire reinforcement

* only with intermediate dies

PRICES ON APPLICATION