

SERIES 630 - HYDRAULIC TOP LINK (RAPID HOOK)

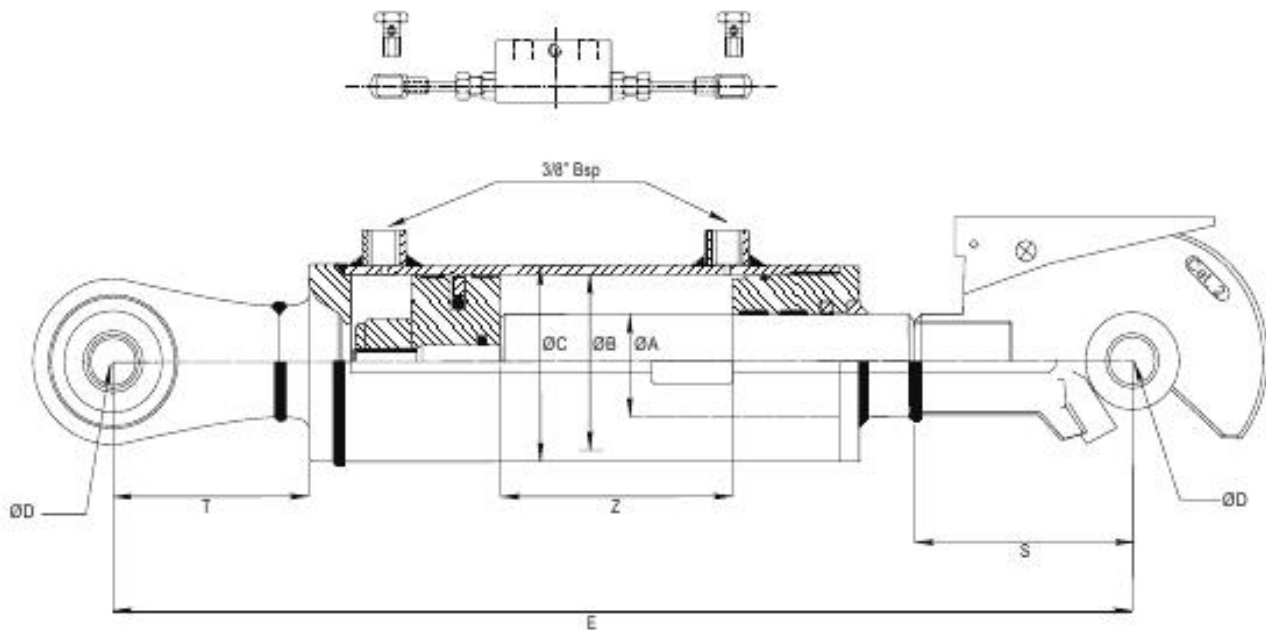

Working pressure: 180 bars.
 Speed: 0.5 m/s.
 Working temperature: -25°C - +80°C.
 Oil: Mineral oil.
 Rod: C45 f7 25 microns.
 Tube: St52.3 Din2393 Iso H9

Option : Dual pilot operated check valve set. (VADP008EX).
 Ball joints and rapid hook welded.

ORDER CODE	ØA	Z STROKE	E	B	C	ØD	S	RANGE	T	VOL	WEIGHT
630/020	35	200	550	60	70	19.40	105	Cat.2	95	0.55	12.5
630/025		250	600		70	20.40				0.7	13.5
631/020		200	550	70	80	22.40				0.95	14
631/025		250	600	80	95	25.40				1.15	15.5
632/020	40	200	600	80	95	25.40	132	Cat.3	95	1.1	18
632/025		250	650		90	105				28.40	1.35
633/020		200	600	90	105	30.40				1.3	19.5
633/025		250	650	100	115	32.40				1.65	22
634/020	45	200	600	100	115	32.40				1.55	22.5
634/02		250	650							1.9	25.5