

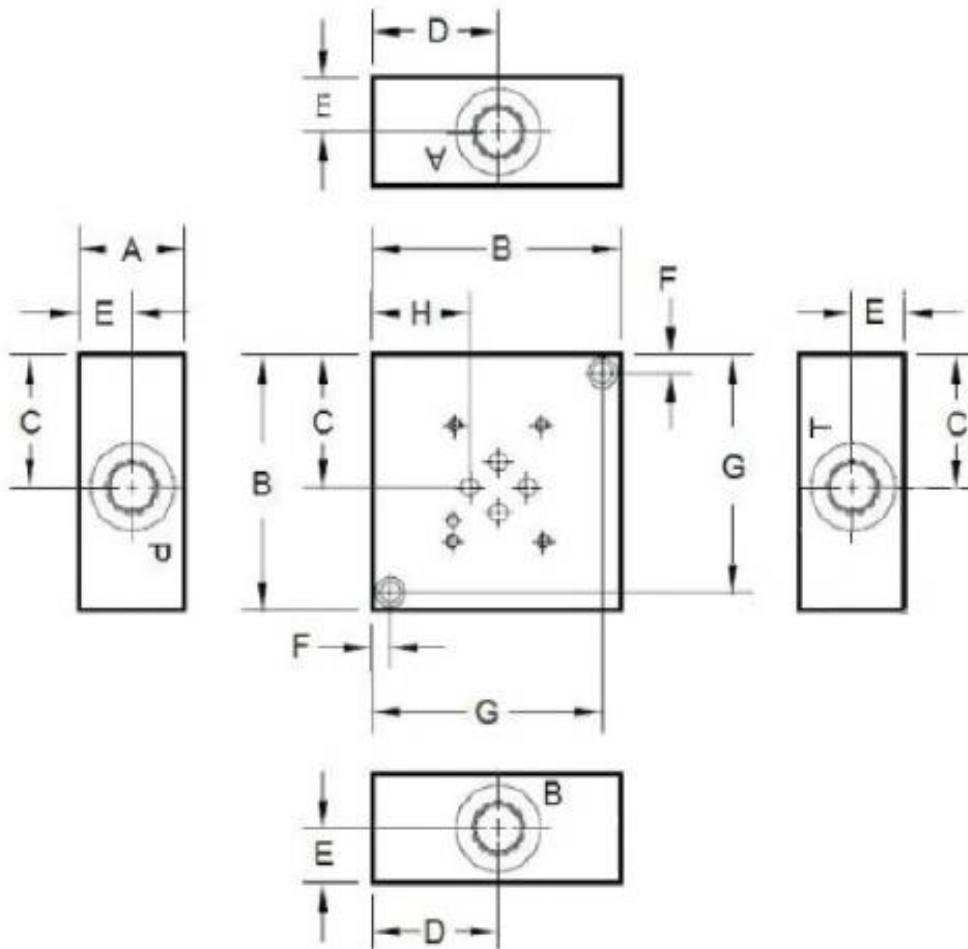

## FLOWFIT CETOP 3 NG6 STEEL SUBPLATE WITH SIDE PORTS

The Flowfit CETOP 3 subplate is machined from steel and is available with 3/8" BSP, 1/2" BSP or 3/4" BSP side ports.

### SPECIFICATION



PRODUCT REFERENCE	PORT SIZE	DIMENSIONS							
		A	B	C	D	E	F	G	H
D-03-SP-S-6G	3/8" BSP	25.4	63.5	33.3	31.8	12.7	6.4	57.2	22.4
D-03-SP-S-8G	1/2" BSP	38.1	88.9	46	45.2	19.1	6.4	82.6	34.9
D-03-SP-S-12G	3/4" BSP	44.5	102	52.4	51.6	22.2	9.5	92.1	41.3