

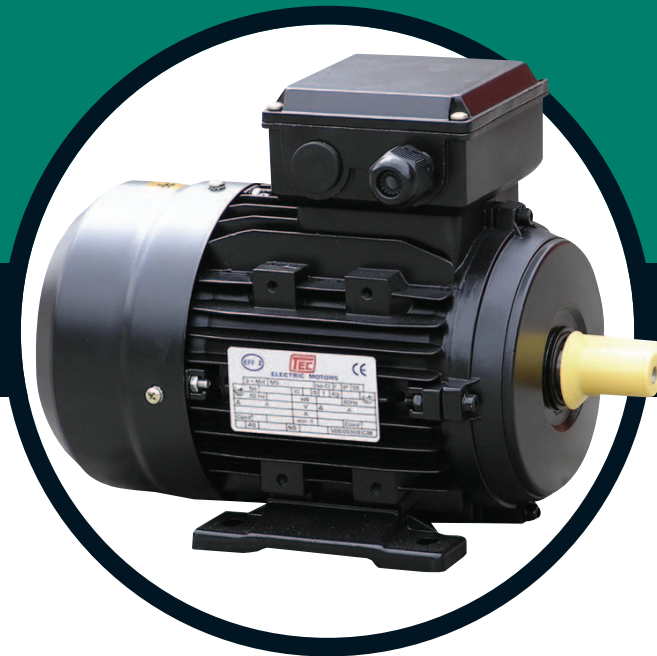

ELECTRIC MOTORS



SERIES ALUMINIUM HOUSING SINGLE-PHASE 240V MULTI-MOUNT ASYNCHRONOUS MOTOR-DUAL CAPACITORS.....628
WIRING DIAGRAMS.....628
OVERALL & INSTALLATION DIMENSIONS.....629
TECHNICAL DATA @ 110V/50HZ.....630
TECHNICAL DATA @ 230V/50HZ.....630
SERIES ALUMINIUM HOUSING THREE-PHASE MULTI-MOUNT ASYNCHRONOUS MOTOR631
WIRING DIAGRAMS.....632
OVERALL & INSTALLATION DIMENSIONS ALUMINIUM HOUSING633
TECA SERIES IE1 EFFICIENCY MOTORS TECHNICAL DATA (AT 50HZ) ALUMINIUM HOUSING.....633
OVERALL & INSTALLATION DIMENSIONS CAST IRON HOUSING.....634
IE1 EFFICIENCY MOTORS TECHNICAL DATA CAST IRON HOUSING.....635



SERIES ALUMINIUM HOUSING SINGLE-PHASE 240V MULTI-MOUNT ASYNCHRONOUS MOTOR-DUAL CAPACITORS

TCC aluminium multi-mount single phase 240V dual capacitor asynchronous motors are manufactured to the latest design. All motors conform to IEC standards and offer a comprehensive range up to 3.7KW and aesthetically pleasing design with the flexibility of a

multi-mount terminal box and available in all mounting configurations including B14B and B5R. They are suitable for applications where torque requirements are 1.8-2.5 times F.L.T.



PART NO	DESCRIPTION	LIST PRICE
0.3741TCCB35	0.37kw 4 Pole B35 1 Phase 240V 160mm DIA 14mm Shaft D71 CAP Start - CAP Run	£174.01



PART NO	DESCRIPTION	LIST PRICE
0.5541TCCB35	0.55kw 4 Pole B35 1 Phase 240V 200mm DIA 19mm Shaft D80 CAP Start - CAP Run	£228.96



PART NO	DESCRIPTION	LIST PRICE
0.7541TCCB35	0.75kw 4 Pole B35 1 Phase 240V 200mm DIA 19mm Shaft D80 CAP Start - CAP Run	£247.28



PART NO	DESCRIPTION	LIST PRICE
1.141TCCB35	1.1kw 4 Pole B35 1 Phase 240V 200mm DIA 24mm Shaft D90S CAP Start - CAP Run	£304.52



PART NO	DESCRIPTION	LIST PRICE
1.541TCCB35	1.5kw 4 pole B35 1 Phase 240V 200mm DIA 24mm Shaft D90L CAP Start - CAP Run	£368.63



PART NO	DESCRIPTION	LIST PRICE
2.241TCCB35	2.2kw 4 Pole B35 1 Phase 240V 250mm DIA 28mm Shaft D100 CAP Start - CAP Run	£485.40



PART NO	DESCRIPTION	LIST PRICE
3.041TCCB35	3kw 4 Pole B35 1 Phase 240V 250mm DIA 28mm Shaft D100 CAP Start - CAP Run	£680.01



PART NO	DESCRIPTION	LIST PRICE
3.741TCCB35	3.7kw 4 Pole B35 1 Phase 240V 250mm DIA 28mm Shaft D112 CAP Start - CAP Run	£778.46

N.B.: it is recommended that single phase motors are not stop/started more than 15 times within a 1 hour period in order to allow safe discharge of capacitors.

WIRING DIAGRAMS



TCC

SERIES ALUMINIUM HOUSING SINGLE-PHASE MULTI-MOUNT ASYNCHRONOUS MOTOR - DUAL CAPACITORS



TCC aluminium multi-mount single phase dual capacitor asynchronous motors are manufactured to the latest design. All motors conform to IEC standards and offer a comprehensive range up to 3.7KW and an aesthetically pleasing design with the flexibility of a multi-mount terminal box and available in all mounting configurations including B14B and B6R. They are suitable for applications where starting torque requirements are 1.8-2.5 times FL.T.

N.B.: it is recommended that single phase motors are not stop/started more than 15 times in 1 hour in order to allow safe discharge of capacitors

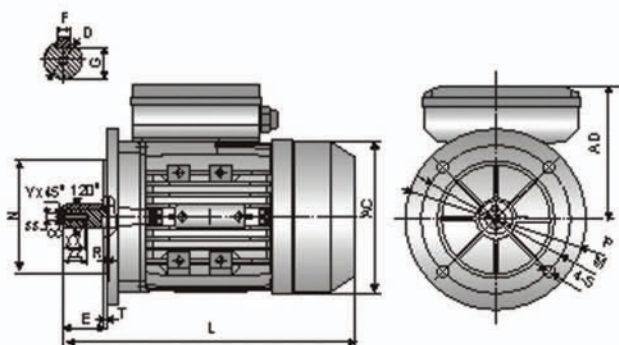

OVERALL & INSTALLATION DIMENSIONS

Frame Size	MOUNTING DIMENSIONS															OVERALL DIMENSIONS					SHAFT END SCREW DIMENSIONS										
	IMB14															IMB6															
	A	B	C	D	E	F	G	H	K	M	N	P	R	S	T	M	N	P	R	S	T	AA	AC	AD	HD	L	SS	XX	ZZ	CC	Y
63	100	80	40	11	23	4	8.5	63	7X10	75	60	90	0	M5	2.5	115	95	140	0	φ 10	3.0	120	130	179	116	212	M4	10	15	3.3	0.8
71	112	90	45	14	30	5	11	71	7X10	85	70	105	0	M6	2.5	130	110	160	0	φ 10	3.5	132	145	194	123	255	M5	12	18	4.2	0.8
80	125	100	50	19	40	6	15.5	80	10X13	100	80	120	0	M6	3.0	165	130	200	0	φ 12	3.5	157	165	223	143	290	M6	16	22	5	1
90S	140	100	56	24	50	8	20	90	10X13	115	95	140	0	M8	3.0	165	130	200	0	φ 12	3.5	172	185	240	150	335	M8	20	25	6.8	1
90L	140	125	56	24	50	8	20	90	10X13	115	95	140	0	M8	3.0	165	130	200	0	φ 12	3.5	172	185	240	150	365	M8	20	25	6.8	1
100L	160	140	63	28	60	8	24	100	12X15	130	110	160	0	M8	3.5	215	180	250	0	φ 15	4.0	196	205	260	160	445	M10	22	28	8.5	1.5
112M	190	140	70	28	60	8	24	112	12X15	130	110	160	0	M8	3.5	215	180	250	0	φ 15	4.0	222	230	295	183	453	M10	22	28	8.5	1.5

TECHNICAL DATA @ 110V/50HZ

Model	Power (kW)	Current (A)	Speed (r/min)	Eff. (%)	Power Factor	Rated Torque (N.m)	Tstart/Tn (Times)	Tmax/Tn (Times)	Starting Current (A)	Run Capacitor (µf/V)	Start Capacitor (µf/V)	Noise dB(A)	Wt. (Kg)
		110V											
TCC631-2	0.18	2.89	2710	63	0.9	0.63	1.8	1.6	16	30 µ F/250V	100µ F/125V	70	4.2
TCC632-2	0.25	3.95	2710	64	0.9	0.88	1.8	1.6	20	40 µ F/250V	100µ F/125V	73	4.7
TCC711-2	0.37	5.40	2780	67	0.93	1.27	2.0	1.8	30	40 µ F/250V	200µ F/125V	75	5.3
TCC712-2	0.55	7.68	2790	70	0.93	1.88	2.0	1.8	40	60 µ F/250V	300µ F/125V	76	7.4
TCC801-2	0.75	9.97	2800	72	0.95	2.56	2.5	1.8	60	80 µ F/250V	400µ F/125V	76	9.5
TCC802-2	1.1	14.04	2810	75	0.95	3.74	2.5	1.8	80	100 µ F/250V	600µ F/125V	79	11.2
TCC90S-2	1.5	18.89	2810	76	0.95	5.10	2.5	1.8	110	140 µ F/250V	800µ F/125V	84	14
TCC90L-2	2.2	27.34	2810	77	0.95	7.48	2.5	1.8	150	180 µ F/250V	1000µ F/125V	84	17
TCC100L-2	3.0	36.34	2830	79	0.95	10.13	2.5	1.7	220	180 µ F/250V	1400µ F/125V	88	25
TCC631-4	0.12	2.20	1350	55	0.9	0.85	2.5	1.8	12	30 µ F/250V	100µ F/125V	64	4.1
TCC632-4	0.18	3.25	1350	56	0.9	1.27	1.8	1.6	17	40 µ F/250V	100µ F/125V	64	4.4
TCC711-4	0.25	4.21	1380	60	0.9	1.73	1.8	1.7	20	40 µ F/250V	150µ F/125V	66	5.9
TCC712-4	0.37	5.93	1380	63	0.9	2.56	2.0	1.7	30	40 µ F/250V	200µ F/125V	68	6.9
TCC801-4	0.55	8.42	1400	66	0.9	3.75	2.0	1.8	40	70 µ F/250V	300µ F/125V	71	9.6
TCC802-4	0.75	10.98	1410	69	0.9	5.08	2.5	1.8	60	90 µ F/250V	400µ F/125V	71	10.8
TCC90S-4	1.1	14.73	1410	73	0.93	7.45	2.5	1.8	80	120 µ F/250V	600µ F/125V	74	13.5
TCC90L-4	1.5	19.81	1400	74	0.93	10.24	2.5	1.8	110	140 µ F/250V	800µ F/125V	79	16.5
TCC100L1-4	2.2	28.30	1430	76	0.93	14.70	2.5	1.8	150	170 µ F/250V	1300µ F/125V	79	24
TCC100L2-4	3	38.09	1440	77	0.93	19.91	2.5	1.8	220	200 µ F/250V	1800µ F/125V	83	30

TECHNICAL DATA @ 230V/50HZ

Model	Power (kW)	Current (A)	Speed (r/min)	Eff. (%)	Power Factor	Rated Torque (N.m)	Tstart/Tn (Times)	Tmax/Tn (Times)	Starting Current (A)	Run Capacitor (µf/V)	Start Capacitor (µf/V)	Noise dB(A)	Wt. (Kg)
		230V											
TCC631-2	0.18	1.38	2710	63	0.9	0.63	2.5	1.6	8	10 µ F/450V	30 µ F/250V	70	4.2
TCC632-2	0.25	1.89	2710	64	0.9	0.88	2.5	1.6	10	12 µ F/450V	40 µ F/250V	73	4.7
TCC711-2	0.37	2.66	2780	65	0.93	1.27	2.5	1.8	15	12 µ F/450V	75 µ F/250V	75	5.3
TCC712-2	0.55	3.78	2790	68	0.93	1.88	2.5	1.8	20	16 µ F/450V	100µ F/250V	76	7.4
TCC801-2	0.75	4.87	2800	72	0.93	2.56	2.5	1.8	30	20 µ F/450V	100µ F/250V	76	9.5
TCC802-2	1.1	7.04	2810	73	0.93	3.74	2.5	1.8	40	30 µ F/450V	150µ F/250V	79	11.2
TCC90S-2	1.5	9.48	2810	74	0.93	5.10	2.5	1.8	55	40 µ F/450V	200µ F/300V	84	14
TCC90L-2	2.2	13.57	2810	75	0.94	7.48	2.5	1.8	75	50 µ F/450V	250µ F/300V	84	17
TCC100L-2	3.0	17.83	2830	77	0.95	10.13	2.5	1.7	110	60 µ F/450V	400µ F/300V	88	25
TCC112M1-2	3.7	21.48	2850	78	0.96	12.40	2.5	1.7	140	80 µ F/450V	600µ F/300V	90	30.5
TCC112M2-2	4.0	22.18	2850	80	0.98	13.41	2.5	1.7	150	80 µ F/450V	600µ F/300V	90	31.5
TCC631-4	0.12	1.05	1350	55	0.9	0.85	2.5	1.8	6	10 µ F/450V	30 µ F/250V	64	4.1
TCC632-4	0.18	1.55	1350	56	0.9	1.27	2.5	1.8	8.5	12 µ F/450V	40 µ F/250V	64	4.4
TCC711-4	0.25	2.01	1380	60	0.9	1.73	2.5	1.7	10	12 µ F/450V	50 µ F/250V	66	5.9
TCC712-4	0.37	2.84	1380	63	0.9	2.56	2.5	1.7	15	16 µ F/450V	75 µ F/250V	68	6.9
TCC801-4	0.55	4.03	1400	66	0.9	3.75	2.5	1.8	20	20 µ F/450V	100µ F/250V	71	9.6
TCC802-4	0.75	5.25	1410	69	0.9	5.08	2.5	1.8	30	25 µ F/450V	100µ F/250V	71	10.8
TCC90S-4	1.1	7.24	1410	71	0.93	7.45	2.5	1.8	40	35 µ F/450V	150µ F/250V	74	13.5
TCC90L-4	1.5	9.61	1400	73	0.93	10.24	2.5	1.8	55	40 µ F/450V	200µ F/300V	79	16.5
TCC100L1-4	2.2	13.90	1430	74	0.93	14.70	2.5	1.8	75	50 µ F/450V	300µ F/300V	79	24
TCC100L2-4	3	18.70	1440	75	0.93	19.91	2.5	1.8	110	60 µ F/450V	500µ F/300V	83	30
TCC112M1-4	3.7	21.99	1440	77	0.95	24.55	2.5	1.7	140	80 µ F/450V	600µ F/300V	86	36
TCC112M2-4	4.0	22.41	1440	80	0.97	26.54	2.5	1.7	150	80 µ F/450V	600µ F/300V	86	37.5

SERIES ALUMINIUM HOUSING THREE-PHASE MULTI-MOUNT ASYNCHRONOUS MOTOR

TECA series Aluminium Housing 3 Phase Multi-mount motors up to 200 frame, utilising new automated production technology. The motors are manufactured to IEC standard.

Motors are: Easily maintained, light weight with high performance and low noise levels. The multi-mount design offers both O.E.M and stockist greater flexibility where terminal box position is important.

Note – Motors up to and including 15kw are Aluminium housings. 18.5kw upwards are Cast Iron Housing.

Series Three-Phase Induction Motors Cast Iron Housing

Multi-mount from 80 to 200 frame

- Frame size H63-355
- Power 0.12~315kw
- Synchronous speed 3000; 1500; 1000; 750RPM
- Voltage 230/400V; 400/690V
- Frequency 50Hz, 60Hz
- Protection class IP55
- Insulation class F
- Ambi temperature -30~+40°C
- Altitude above sea level ≤ 1000m



PART NO	DESCRIPTION	LIST PRICE
0.3743TECAB35	0.37kw 3PH B35 4 Pole 415V 160mm, Shaft DIA 14mm TECA Aluminium Housing	£174.01

PART NO	DESCRIPTION	LIST PRICE
0.5543TECAB35	0.55kw 3PH B35 4 Pole 415V 200mm, Shaft DIA 19mm TECA Aluminium Housing	£119.06

PART NO	DESCRIPTION	LIST PRICE
0.7543TECAB35-IE2	0.75kw 3PH B35 4 Pole 415V 200mm, Shaft DIA 19mm TECA Aluminium Housing	£189.03

PART NO	DESCRIPTION	LIST PRICE
1.143TECAB35-IE2	1.1kw 3PH B35 4 Pole 415V 200mm, Shaft DIA 24mm TECA Aluminium Housing	£244.35

PART NO	DESCRIPTION	LIST PRICE
1.543TECAB35-IE2	1.5kw 3PH B35 4 Pole 415V 200mm, Shaft DIA 24mm TECA Aluminium Housing	£288.28

PART NO	DESCRIPTION	LIST PRICE
2.243TECAB35-IE2	2.2kw 3PH B35 4 Pole 415V 250mm, Shaft DIA 28mm TECA Aluminium Housing	£324.70

PART NO	DESCRIPTION	LIST PRICE
3.043TECAB35-IE2	3kw 3PH B35 4 Pole 415V 250mm, Shaft DIA 28mm TECA Aluminium Housing	£369.20

PART NO	DESCRIPTION	LIST PRICE
4.043TECAB35-IE2	4kw 3PH B35 4 Pole 415V 250mm, Shaft DIA 28mm TECA Aluminium Housing	£498.49

PART NO	DESCRIPTION	LIST PRICE
5.543TECAB35-IE2	5.5kw 3PH B35 4 Pole 415V 300mm, Shaft DIA 38mm TECA Aluminium Housing	£636.36

PART NO	DESCRIPTION	LIST PRICE
7.543TECAB35-IE2	7.5kw 3 PH B35 4 Pole 415V 300mm, Shaft DIA 38mm TECA Aluminium Housing	£722.10



PART NO	DESCRIPTION	LIST PRICE
11.043TECAB35-IE2	11kw 3PH B35 4 Pole 415V 350mm, Shaft 42mm DIA - D160L TECA Aluminium Housing	£1142.22



PART NO	DESCRIPTION	LIST PRICE
15.043TECAB35-IE2	15kw 3PH B35 4 Pole 415V 350mm, Shaft 42mm DIA - D180L TECA Aluminium Housing	£1285.15



PART NO	DESCRIPTION	LIST PRICE
18.543TECCB35-IE2	18.5kw 3PH B35 4 Pole 415V 350mm, Shaft 48mm DIA - D200L2 TCC Cast Iron Housing ECOL Motor Range	£1387.09



PART NO	DESCRIPTION	LIST PRICE
22.043TECCB35-IE2	22kw 3PH B35 4 Pole 415V 350mm, Shaft 48mm DIA - D200L2 TCC Cast Iron Housing ECOL Motor Range	£1774.18



PART NO	DESCRIPTION	LIST PRICE
30.043TECCB35-IE2	30kw 3PH B35 4 Pole 415V 400mm, Shaft 55mm DIA - D225M TCC Cast Iron Housing ECOL Motor Range	£2538.65



PART NO	DESCRIPTION	LIST PRICE
37.043TECCB35-IE2	37kw 3PH B35 4 Pole 415V 450mm, Shaft 60mm DIA - D250M TCC Cast Iron Housing ECOL Motor Range	£2635.76



PART NO	DESCRIPTION	LIST PRICE
45.043TECCB35-IE2	45kw 3PH B35 4 Pole 415V 450mm, Shaft 75mm DIA - D2805 TCC Cast Iron Housing ECOL Motor Range	£3367.86



PART NO	DESCRIPTION	LIST PRICE
55.043TECCB35-IE2	55kw 3PH B35 4 Pole 415V 450mm, Shaft 75mm DIA - D280M TCC Cast Iron Housing ECOL Motor Range	£3653.82



PART NO	DESCRIPTION	LIST PRICE
75.043TECCB35-IE2	75kw 3PH B35 4 Pole 415V 550mm, Shaft 80mm DIA - D3158 TCC Cast Iron Housing ECOL Motor Range	£4592.49



PART NO	DESCRIPTION	LIST PRICE
90.043TECCB35-IE2	90kw 3PH B35 4 Pole 415V 550mm, Shaft 80mm DIA - D315M TCC Cast Iron Housing ECOL Motor Range	£5939.66



PART NO	DESCRIPTION	LIST PRICE
110.043TECCB35-IE2	110kw 3PH B35 4 Pole 415V?? 550mm, Shaft 80mm DIA - D315L TCC Cast Iron Housing ECOL Motor Range	£10601.16

WIRING DIAGRAMS



OVERALL & INSTALLATION DIMENSIONS ALUMINIUM HOUSING

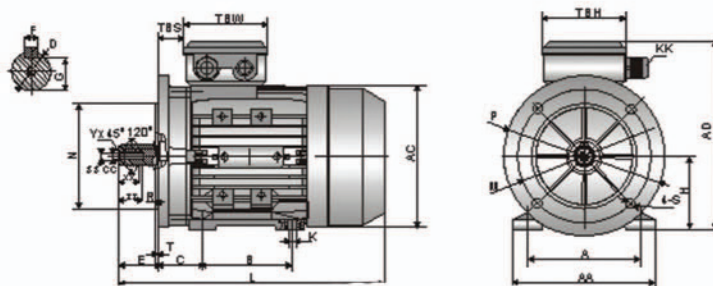

IMB35

B35 Overall & Installation Dimensions

FRAME	H	B35						B35R						A	B	C	D	E	F
		M	N	P	T	R	S	M	N	P	T	R	S						
56	56	Φ100	Φ80	Φ120	3.0	0	Φ7							90	71	36	Φ9	20	3
63	63	Φ115	Φ95	Φ140	3.0	0	Φ10							100	80	40	Φ11	23	4
71**	71	Φ130	Φ110	Φ160	3.5	0	Φ10	Φ115	Φ95	Φ140	3.5	0	Φ10	112	90	45	Φ14	30	5
80	80	Φ165	Φ130	Φ200	3.5	0	Φ12	Φ130	Φ110	Φ160	4.0	0	Φ10	125	100	50	Φ19	40	6
90S	90	Φ165	Φ130	Φ200	3.5	0	Φ12	Φ130	Φ110	Φ160	4.0	0	Φ10	140	100	56	Φ24	50	8
90L1/L2	90	Φ165	Φ130	Φ200	3.5	0	Φ12	Φ130	Φ110	Φ160	3.5	0	Φ10	140	125	56	Φ24	50	8
100**	100	Φ215	Φ180	Φ250	4.0	0	Φ15	Φ165	Φ130	Φ200	4.0	0	Φ12	160	140	63	Φ28	60	8
112	112	Φ215	Φ180	Φ250	4.0	0	Φ15	Φ165	Φ130	Φ200	4.0	0	Φ12	190	140	70	Φ28	60	8
132S	132	Φ265	Φ230	Φ300	4.0	0	Φ15	Φ215	Φ180	Φ250	4.0	0	Φ15	216	140	89	Φ38	80	10
132M/L	132	Φ265	Φ230	Φ300	4.0	0	Φ15	Φ215	Φ180	Φ250	4.0	0	Φ15	216	178	89	Φ38	80	10
160M/L	160	Φ300	Φ250	Φ350	5.0	0	Φ19							254	210/254	108	Φ42	110	12
180M/L	180/160	Φ300	Φ250	Φ350	5.0	0	Φ19							279	241/279	121	Φ48	110	14
200L	200	Φ350	Φ300	Φ400	5.0	0	Φ19							318	305	133	Φ55	110	16

FRAME	G	K	KK	AA	AD	AC	L	LccL	TBS	TBW	TBH	SS	XX	ZZ	CC	Y
56	7.2	5.8x5.8	1-M16X1.5	110	156	Φ117	196	232	14	88	88	M3	9	12	2.5	0.5
63	8.5	7x10	1-M16X1.5	120	171	Φ130	220	258	14	94	94	M4	10	14	3.3	0.8
71**	11	7x10	1-M20X1.5	132	186	Φ147	241(255)	282(296)	20	94	94	M5	12	17	4.2	0.8
80	15.5	10x13	1-M20X1.5	160	213	Φ163	290	339	27	105	105	M6	16	21	5	1
90S	20	10x13	1-M20X1.5	175	229	Φ183	312	361	30	105	105	M8	19	25	6.8	1
90L1/L2	20	10x13	1-M20X1.5	175	229	Φ183	337/387	386/416	30	105	105	M8	19	25	6.8	1
100**	24	12x15	2-M20X1.5	198	252	Φ205	369(387)	425(443)	26	105	105	M10	22	30	8.5	1.5
112	24	12x15	2-M25X1.5	220	279	Φ229	395	463	32	112	112	M10	22	30	8.5	1.5
132S	33	12x15	2-M25X1.5	252	318	Φ265	437	497	38	112	112	M12	28	37	10.2	1.5
132M/L	33	12x15	2-M25X1.5	252	318	Φ265	475/501	535/561	38	112	112	M12	28	37	10.2	1.5
160M/L	37	15x19	2-M32X1.5	290	384	Φ325	640	697	64	143	143	M16	36	45	14.2	2
180M/L	42.5	15x25	2-M32X1.5	340	440	Φ368	730		73	190	190	M16	36	45	14.2	2
200L	49	19x29	2-M40X1.5	390	460	Φ368	745		85	190	190	M20	42	53	17.5	2

TECA SERIES IE1 EFFICIENCY MOTORS TECHNICAL DATA (AT 50HZ) ALUMINIUM HOUSING

Model	Power (KW)	Current (A)			Current (A)			Current (A)			Speed (r/min)	Eff. (%)	Power Factor	Tstart/Tn (Times)	Tmax/Tn (Times)	Tmin/Tn (Times)	Is/In (Times)	Noise dB(A)	Wt. (Kg)
		220V	380V	660V	230V	400V	690V	240V	415V	720V									
TECA712-4	0.37	2.02	1.17	0.67	1.92	1.11	0.64	1.85	1.07	0.62	1370	65	0.74	2.2	2.4	1.7	6	55	5.80
TECA713-4	0.55	2.92	1.69	0.97	2.78	1.60	0.93	2.67	1.55	0.89	1380	66	0.75	2.2	2.4	1.7	6	57	6.50
TECA801-4	0.55	2.87	1.66	0.96	2.74	1.58	0.91	2.63	1.52	0.88	1370	67	0.75	2.2	2.4	1.7	6	58	8.10
TECA802-4	0.75	3.50	2.03	1.17	3.34	1.93	1.11	3.21	1.86	1.07	1380	72	0.78	2.2	2.4	1.6	6	58	9.10
TECA803-4	1.1	4.86	2.81	1.62	4.63	2.67	1.54	4.45	2.57	1.48	1380	76.2	0.78	2.2	2.4	1.6	6	60	11.00
TECA90S-4	1.1	4.80	2.78	1.60	4.57	2.64	1.52	4.40	2.54	1.47	1400	76.2	0.79	2.2	2.4	1.6	6	61	11.70
TECA90L1-4	1.5	6.27	3.63	2.09	5.97	3.45	1.99	5.75	3.32	1.92	1400	78.5	0.8	2.2	2.4	1.6	6	61	14.40
TECA90L2-4	2.2	8.91	5.16	2.97	8.45	4.90	2.83	8.17	4.72	2.72	1400	81	0.8	2.2	2.4	1.5	7	63	17.60
TECA100L14	2.2	8.80	5.09	2.93	8.38	4.84	2.79	8.07	4.66	2.69	1420	81	0.81	2.2	2.3	1.5	7	64	19.20
TECA100L24	3	11.8	6.81	3.92	11.2	6.47	3.74	10.8	6.24	3.60	1420	82.6	0.81	2.2	2.3	1.5	7	64	22.50
TECA100L34	4	15.2	8.80	5.07	14.2	8.36	4.89	13.9	8.06	4.65	1430	84.2	0.82	2.2	2.3	1.5	7	65	27.30
TECA112M-4	4	15.0	8.70	5.01	14.3	8.28	4.77	13.8	7.96	4.59	1400	84.2	0.83	2.2	2.2	1.5	7	65	29.00
TECA112L-4	5.5	20.3	11.7	6.76	19.3	11.2	6.44	18.6	10.8	6.20	1440	85.7	0.83	2.2	2.2	1.4	7	68	35.70
TECA132S-4	5.5	20.1	11.6	6.68	19.1	11.0	6.37	18.4	10.6	6.13	1450	85.7	0.84	2.2	2.2	1.4	7	71	39.00
TECA132M-4	7.5	26.6	15.4	8.87	25.4	14.6	8.45	24.4	14.1	8.13	1450	87	0.85	2.2	2.2	1.4	7	71	48.60
TECA132L14	9.2	32.5	18.8	10.8	30.9	17.9	10.3	29.8	17.2	9.9	1460	87.5	0.85	2.2	2.2	1.4	7.5	74	56.50
TECA132L24	11	38.0	22.0	12.7	36.2	20.9	12.1	34.8	20.1	11.6	1460	88.4	0.86	2.2	2.2	1.4	7.5	74	64.00
TECA160M-4	11	37.5	21.7	12.5	35.8	20.6	11.9	34.4	19.9	11.5	1460	88.4	0.87	2.2	2.2	1.4	7	75	73.00
TECA160L14	15	51.2	29.6	17.1	48.8	28.2	16.3	46.9	27.1	15.6	1460	88.4	0.87	2.2	2.2	1.4	7.5	75	88.50

OVERALL & INSTALLATION DIMENSIONS CAST IRON HOUSING

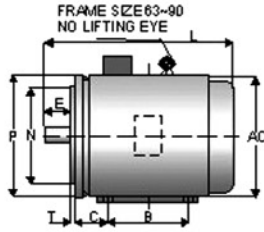

FRAME SIZE 63-132

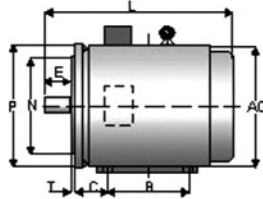

FRAME SIZE 160-355

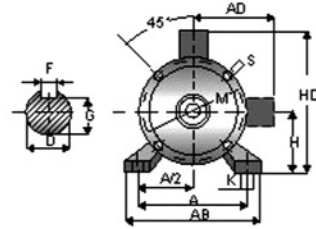

FRAME SIZE 63-200

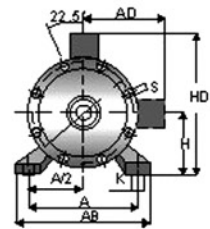

FRAME SIZE 225-355

Frame No.	Poles	Mounting Dimensions & Tolerance																Frame Dimensions														
		A	A/2	B	C	D	E	F	G ⁽¹⁾	H	K ⁽²⁾	M	N	P ⁽³⁾	R ⁽⁴⁾	S	T	Holes No.	AB	AC	AD	HD	L									
80M	2, 4, 6, 8	125	63	100	50	19	40	6	16	80	10								4	165	130	200	12	3.5	4	165	175	145	220	295		
90S		140	70	100	56	24	50	+0.310		20	90																180	195	155	250	320	
90L				125								12																				345
100L			160	80	140	63	28	60	0	24	100	0												+0.43			205	215	180	270	385	
112M			190	95	140	70	±2.0	60	0		112	-0.5	130	180	250												230	240	190	300	400	
132S			216	108	140	89		80	+0.370																							470
132M					178										300																	510
160M			254	127	210	108	42	110	+0.018		12	37																				615
160L					254				+0.002																							670
180M			279	140	241	121	±3.0	110	+0.430		14	43			350																	700
180L					279																											740
200L			318	159	305	133					16	49			400																	770
225S		4, 8			286		60	140	+0.500	18	0	53																				815
225M		2	355	178		149	55	110	+0.430	16		53																				820
	4, 6, 8			311																											845	
250M	2					60					49																				910	
	4, 6, 8	405	203	349	168					18																						
280S	2					65					58																				985	
	4, 6, 8			368		75	140			20	0	68	±0.020	550																		
280M	2	457	229		190	65				18	0	58																			1035	
	4, 6, 8, 10			419		75	+0.030	+0.011		18	0	58																				
315S	2					65				18	0	58																			1185	
	4, 6, 8, 10			406		80				22	0	71																			1215	
315M	2	508	254	457	216	65	140			18	0	58																			1295	
	4, 6, 8, 10					80	170	+0.500		22	0	71																			1325	
315L	2					65	140			18	0	58																			1295	
	4, 6, 8, 10			508		80	170			22	0	71																			1325	
355M	2					75	140			20	0	68																			1500	
	4, 6, 8, 10	610	305	560	254	100	210	+0.035	+0.013	28	0	90																			1570	
355L	2					75	140			20	0	68																			1500	
	4, 6, 8, 10			630		100	210	+0.035	+0.013	28	0	90																			1570	

IE1 EFFICIENCY MOTORS TECHNICAL DATA CAST IRON HOUSING

Model	Rated output (kW)	At full load				Locked current Rated current	Locked torque Rated torque	Max torque Rated torque	Net weight (kg)	Noise level dBA	
		Speed (r/min)	Current (A)	Ef. (%)	Power factor (cos φ)					I	II
180M	18.5	1470	34.3	90.5	0.86	7.5	2.2		182	76	80
180L	22		40.6	91					190		
200L	30		54.7	92					270		
225S	37	1480	66.4	92.5	0.87	7.2			284	81	85
225M	45		80.5	92.8					320		84
250M	55		98.1	93					427	86	
280S	75		132.7	93.8					562	86	89
280M	90		158.5	94.2					667		
315S	110		191.0	94.5					0.88	6.9	2.1
315M	132	228.4	94.8	1100							
315L1	160	273.4	94.9	0.89	1160	97	100				
315L2	200	334.4	95					1270			
355M	250	420.7	95.3	0.90	1700	101	104				
355L	315	528.4	95.6					1850			