



# WE - VERSCHRAUBUNGEN

## WE - STUD ELBOWS



PRODUKTE / PRODUCTS

ERLÄUTERUNG / EXPLANATION

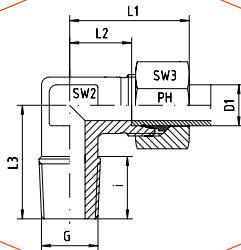

Winkel-Einschraubverschraubungen  
LL- und L-Reihe  
Einschraubgewinde: NPT

Stud Elbows  
LL- and L-Series  
Thread: NPT

Reihe Series	Druck Pressure PN	Rohr A.D. Tube O.D. D1	Gewinde Thread G	Ca. Maße Approx. Dimensions						Bestellzeichen Order-Code Standard
				L1	L2	L3	i	SW2	SW3	
L	315	6	1/8" NPT	27,0	12,0	20	10,0	12	14	WE6L-2N
L	315	6	1/4" NPT	29,0	14,0	26	15,0	12	14	WE6L-4N
L	315	6	3/8" NPT	33,0	18,0	28	15,3	14	14	WE6L-6N
L	315	6	1/2" NPT	30,5	15,5	30	20,0	17	14	WE6L-8N
L	315	8	1/8" NPT	29,0	14,0	26	10,0	12	17	WE8L-2N
L	315	8	1/4" NPT	29,0	14,0	26	15,0	12	17	WE8L-4N
L	315	8	3/8" NPT	29,0	14,0	26	15,3	14	17	WE8L-6N
L	315	8	1/2" NPT	34,5	19,5	30	20,0	17	17	WE8L-8N
L	315	10	1/8" NPT	30,0	15,0	27	10,0	14	19	WE10L-2N
L	315	10	1/4" NPT	30,0	15,0	27	15,0	14	19	WE10L-4N
L	315	10	3/8" NPT	32,0	17,0	28	15,3	14	19	WE10L-6N
L	315	10	1/2" NPT	37,0	21,0	33	20,0	17	19	WE10L-8N
L	315	12	1/8" NPT	32,0	17,0	28	10,0	17	22	WE12L-2N
L	315	12	1/4" NPT	32,0	17,0	28	15,0	17	22	WE12L-4N
L	315	12	3/8" NPT	32,0	17,0	28	15,3	17	22	WE12L-6N
L	315	12	1/2" NPT	36,0	21,0	34	20,0	17	22	WE12L-8N
L	315	15	3/8" NPT	36,0	21,0	34	15,3	19	27	WE15L-6N
L	315	15	1/2" NPT	36,0	21,0	34	20,0	19	27	WE15L-8N
L	160	15	3/4" NPT	36,0	21,0	42	20,0	24	27	WE15L-12N
L	315	18	3/8" NPT	40,0	23,5	36	15,3	24	32	WE18L-6N
L	315	18	1/2" NPT	40,0	23,5	36	20,0	24	32	WE18L-8N
L	160	18	3/4" NPT	38,5	22,0	41	20,0	24	32	WE18L-12N
L	160	22	1/2" NPT	44,0	27,5	42	20,0	27	36	WE22L-8N
L	160	22	3/4" NPT	44,0	27,5	42	20,0	27	36	WE22L-12N
L	160	28	3/4" NPT	47,0	30,5	48	20,0	36	41	WE28L-12N
L	160	28	1" NPT	47,0	30,5	48	25,0	36	41	WE28L-16N
L	160	35	1 1/4" NPT	56,0	34,5	54	25,5	41	50	WE35L-20N
L	160	42	1 1/2" NPT	63,0	40,0	61	26,0	50	60	WE42L-24N

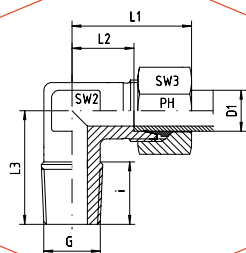

Winkel-Einschraubverschraubungen  
S-Reihe  
Einschraubgewinde: NPT

Stud Elbows  
S-Series  
Thread: NPT

Reihe Series	Druck Pressure PN	Rohr A.D. Tube O.D. D1	Gewinde Thread G	Ca. Maße Approx. Dimensions							Bestellzeichen Order-Code Standard
				L1	L2	L3	i	SW2	SW3		
S	630	6	1/4" NPT	31	16,0	26	15,0	12	17	WE6S-4N	
S	630	6	3/8" NPT	32	17,5	27	15,3	14	17	WE6S-6N	
S	630	6	1/2" NPT	36	21,0	34	20,0	17	17	WE6S-8N	
S	630	8	1/4" NPT	32	17,0	27	15,0	14	19	WE8S-4N	
S	630	8	3/8" NPT	33	18,0	28	15,3	14	19	WE8S-6N	
S	630	8	1/2" NPT	38	23,0	34	20,0	17	19	WE8S-8N	
S	630	10	1/4" NPT	34	17,5	28	15,0	17	22	WE10S-4N	
S	630	10	3/8" NPT	34	17,5	28	15,3	17	22	WE10S-6N	
S	630	10	1/2" NPT	39	22,5	32	20,0	17	22	WE10S-8N	
S	630	12	1/4" NPT	38	21,5	29	15,0	17	24	WE12S-4N	
S	630	12	3/8" NPT	38	21,5	28	15,3	17	24	WE12S-6N	
S	630	12	1/2" NPT	39	21,5	34	20,0	17	24	WE12S-8N	
S	630	14	3/8" NPT	40	22,0	30	15,3	19	27	WE14S-6N	
S	630	14	1/2" NPT	40	22,0	34	20,0	19	27	WE14S-8N	
S	400	16	3/8" NPT	43	24,5	32	15,3	24	30	WE16S-6N	
S	400	16	1/2" NPT	43	24,5	36	20,0	24	30	WE16S-8N	
S	400	16	3/4" NPT	43	24,5	41	20,0	24	30	WE16S-12N	
S	400	20	1/2" NPT	48	26,5	42	20,0	27	36	WE20S-8N	
S	400	20	3/4" NPT	48	26,5	42	20,0	27	36	WE20S-12N	
S	400	25	1" NPT	54	30,0	48	25,0	36	46	WE25S-16N	
S	400	30	1 1/4" NPT	62	35,5	54	25,5	41	50	WE30S-20N	
S	315	38	1 1/2" NPT	72	41,0	61	26,0	50	60	WE38S-24N	