

SERIES 60000 PTO GEARBOX PUMP GROUP 2 · 10KW

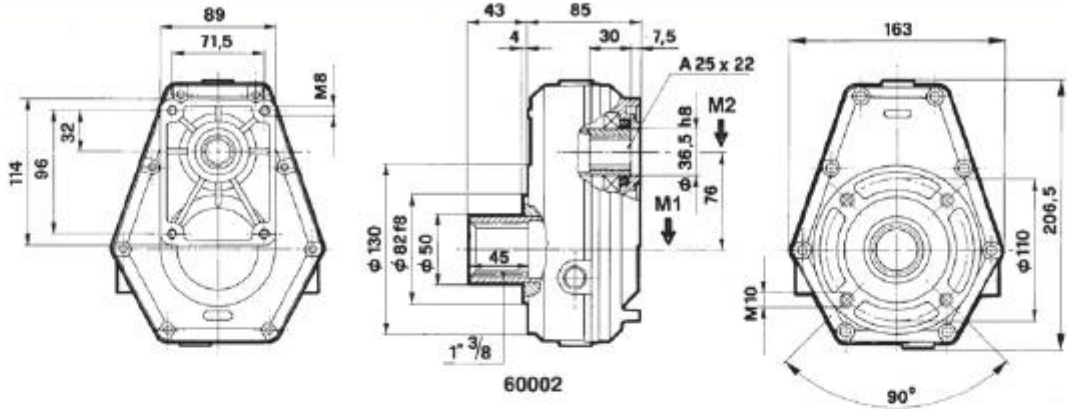

MAX OIL LEVEL 0.22 LITRE

M1 MAXIMUM CONTINUOUS TORQUE OF THE PTO GEARBOX (Input side daNm)	M2 MAXIMUM TORQUE OF THE PTO GEARBOX (Output side daNm)	N1 TRACTOR OUTPUT SPEED RPM	N2 FINAL OUTPUT SPEED OF PUMP/GEARBOX ASSEMBLY RPM	I RATIO OF SPEED INCREASE	KW MAX TRANSMITTABLE POWER	WEIGHT KG
17,8	11,9	540	810	1,5	10	5,5
15,2	7,6	540	1080	2	10	5,5
16,5	6,6	540	1350	2,5	10	5,5
18	5,5	540	1680	3	10	5,5
18,6	5,8	540	1836	3,5	10	5,5
15,9	4,2	540	2052	3,8	10	5,5

FACTORY PREFIX	PTO GEARBOX		RATIO AVAILABLE	
	33	60001	1,5	
	60002	2		
	60003	2,5		
	60004	3		
		3,5		
		3,8		

PART NO.	DESCRIPTION OF PTO GEARBOX
33 - 60001-1	Pto Gearbox gr.2 male shaft R.1:1,5
33 - 60001-2	Pto Gearbox gr.2 male shaft R.1:2
33 - 60001-3	Pto Gearbox gr.2 male shaft R.1:2,5
33 - 60001-4	Pto Gearbox gr.2 male shaft R.1:3
33 - 60001-5	Pto Gearbox gr.2 male shaft R.1:3,5
33 - 60001-6	Pto Gearbox gr.2 male shaft R.1:3,8
33 - 60001-6/9S	Pto Gearbox gr.2 male shaft R.1:3,8 with pinion gear T9 SAE DP
33 - 60001-6/0	Pto Gearbox gr.2 male shaft R.1:3,8 with oil level inverted
33 - 60002-1	Pto Gearbox gr.2 female shaft long R.1:1,5
33 - 60002-2	Pto Gearbox gr.2 female shaft long R.1:2
33 - 60002-3	Pto Gearbox gr.2 female shaft long R.1:2,5
33 - 60002-4	Pto Gearbox gr.2 female shaft long R.1:3
33 - 60002-5	Pto Gearbox gr.2 female shaft long R.1:3,5
33 - 60002-6	Pto Gearbox gr.2 female shaft long R.1:3,8
33 - 60002-6/2L	Pto Gearbox gr.2 female shaft long R.1:3,8 with 2 oil level plugs
33 - 60003-1	Pto Gearbox gr.2 female shaft short R.1:1,5
33 - 60003-2	Pto Gearbox gr.2 female shaft short R.1:2
33 - 60003-3	Pto Gearbox gr.2 female shaft short R.1:2,5
33 - 60003-4	Pto Gearbox gr.2 female shaft short R.1:3
33 - 60003-5	Pto Gearbox gr.2 female shaft short R.1:3,5
33 - 60003-6	Pto Gearbox gr.2 female shaft short R.1:3,8
33 - 60004-1	Pto Gearbox gr.2 female shaft quick-fitting R.1:1,5
33 - 60004-2	Pto Gearbox gr.2 female shaft quick-fitting R.1:2
33 - 60004-3	Pto Gearbox gr.2 female shaft quick-fitting R.1:2,5
33 - 60004-4	Pto Gearbox gr.2 female shaft quick-fitting R.1:3
33 - 60004-4/GC	Pto Gearbox gr.2 female shaft quick-fitting R.1:3 Remac type
33 - 60004-5	Pto Gearbox gr.2 female shaft quick-fitting R.1:3,5
33 - 60004-6	Pto Gearbox gr.2 female shaft quick-fitting R.1:3,8
33 - 60004-6/1PL	Pto Gearbox gr.2 female shaft quick-fitting R.1:3,8 for 1PL pump
33 - 60004-6/GC	Pto Gearbox gr.2 female shaft quick-fitting R.1:3,8 Remac type

If the part number needed is not listed please ask the Flowfit Sales Team

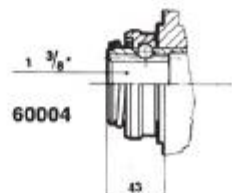
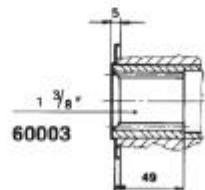
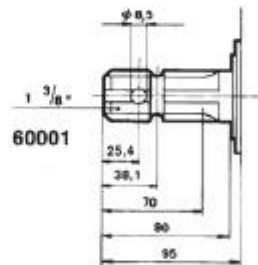

PUMPS GROUP 2 • PERFORMANCE



Flow - Speed chart

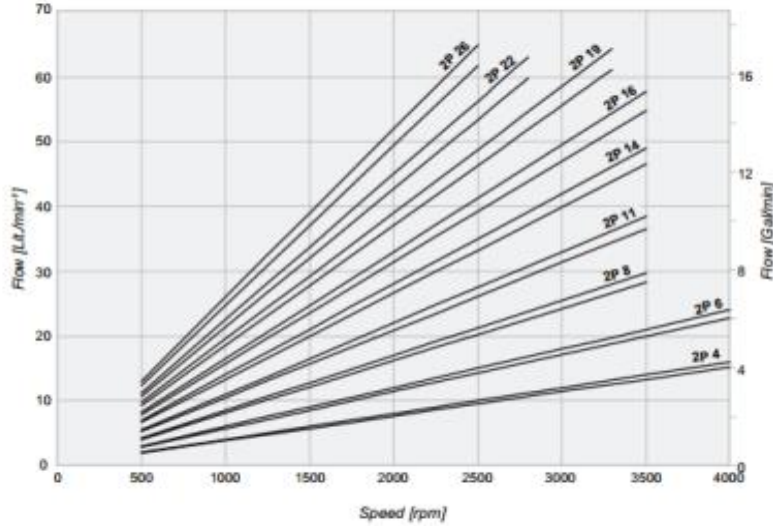

Pumps Group 2 Power and Speed Diagrams

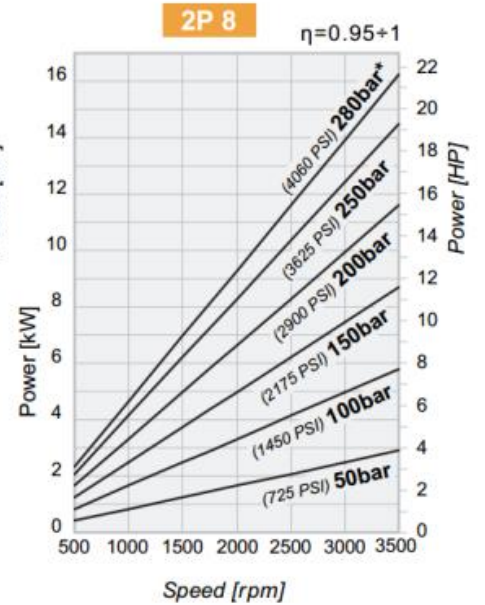
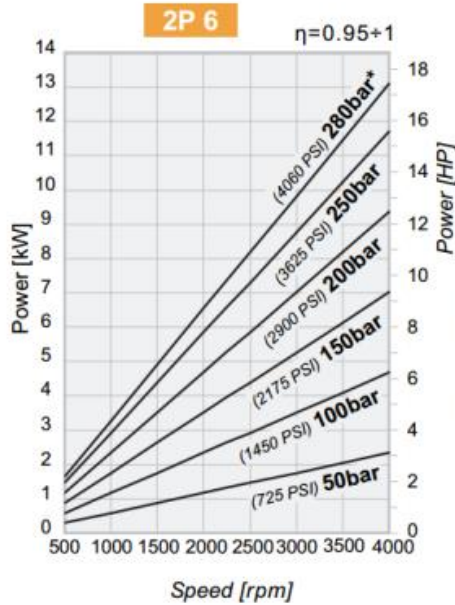
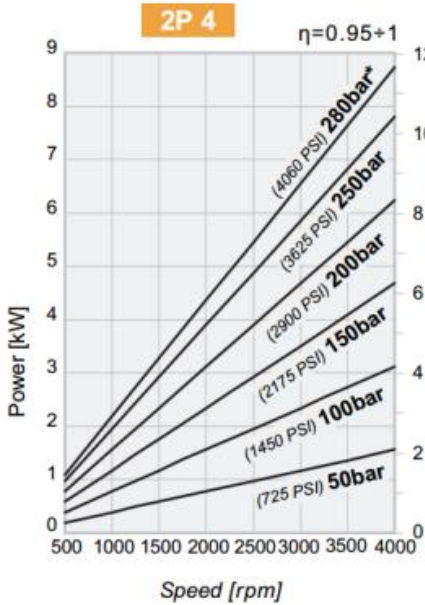

* Only for cast iron pumps

Pumps Group 2 Power and Speed Diagrams

